

# TALLYGAROPNA PRIMARY SCHOOL NO.3067

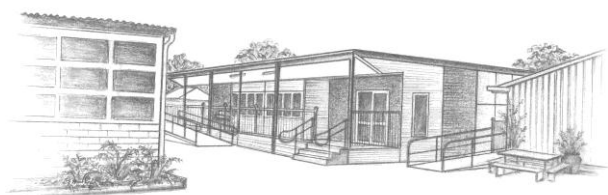

Victoria Street, Tallygaropna

Phone 03 58298264

Fax 03 58298244

[tallygaropna.ps@edumail.vic.gov.au](mailto:tallygaropna.ps@edumail.vic.gov.au)

Website - <http://www.tally-ps-3067.vic.edu.au/>

Mobile 0403625625 / 0411960164

**SCHOOL VALUES - RESPECT, HONESTY & INCLUSION**

## NEWSLETTER

TERM 1 NO.1 6<sup>th</sup> February 2012

### *Contents*

#### *Welcome*

- |                              |                                 |
|------------------------------|---------------------------------|
| 1. Prep Information          | 2. Newsletter / Website         |
| 3. Staffing                  | 4. School Fees for 2012         |
| 5. School Assembly           | 6. EMA                          |
| 7. School Times              | 8. Art / Library Van            |
| 9. Sun Smart Policy          | 10. Religious Education         |
| 11. Lunch Orders - Friday    | 12. Term Dates                  |
| 13. The Ultranet             | 14. Book Club                   |
| 15. Payment Envelopes        | 16. Tallygaropna Steering Group |
| 17. Medicine at School       | 18. Headlice                    |
| 19. Frozen Fruit Freezes     | 20. Kids & Fruit                |
| 21. Fruit in Classrooms      | 22. Conveyance Allowance        |
| 23. Uniform Order            | 24. Parents Club                |
| 25. Student Information      | 26. AASC Program                |
| 27. School Council           | 28. Personal Property           |
| 29. School Photos            | 30. Information Evening         |
| 31. Homework                 | 32. Athletics / Ziptales        |
| 33. I.T. Acceptable Use      | 34. Engagement Policy           |
| 35. You Can Do It            | 36. School Bus Safety           |
| 37. English Online Interview | 38. School Values               |
| 39. Soccer Teams             | 40. Zone Sport                  |

**School Captains & Junior School Council will be announced at Assembly on Monday 13<sup>th</sup> February.**

**An Information & Meet and Greet Evening will be held on Wednesday 15<sup>th</sup> February. The night will begin at 5.30pm and conclude at 6.30pm.**

**All students need to please bring their green reader bags back to school ASAP as they will be used this year to hold their readers,**

**Our first School Council Meeting for the year is scheduled to be held on Wednesday 22<sup>nd</sup> February. Information will be sent home to School Council Members.**

**If you would like to receive this newsletter by email contact our office.**

Hi everyone,

Welcome to the 2012 School Year. I hope everyone had an enjoyable and restful holiday period and I am sure we are all looking forward to an exciting year at Tallygaropna Primary School. Over the holiday period, the teachers have spent a lot of time and effort preparing grades and organising resources and I know the children of our school will enjoy their time at Tally PS this year. Our school is well equipped to cater for 21<sup>st</sup> Century Learning and we can be extremely proud of the resources which we have presently. As always, a number of important forms will go home early in the year – it would be appreciated if these could be returned ASAP to enhance our general management of the school. As stated last year, I will be teaching full time this year and Karen Armstrong (School Bursar) will be in the office from Monday to Thursday to assist any parents if needed.

The school numbers are listed above but if anyone needs to contact me out of school hours, my mobile number is 0411960164. Feel free to see me at school in regard to any matters that arise no matter how trivial they may be. I have an open door policy at school, and I will always seek to do what is best for our children. Apologies for such a large first newsletter, I promise they will be condensed more in the future.

David Brodie – Teaching Principal

There is a late arrivals, early departures (students) and visitor's (parents) book that needs to be signed at the office counter on a regular basis if the need arises. This will aid our emergency management of the school.

This year, we will only have 2 School Captains. There will be one boy and one girl in Grade 6, selected by staff and peers to fulfil these roles. This is an alteration from last year, because of low numbers making it fair for the students involved. All of the other Grade 5/6 students who miss out as being a school captain, will have an opportunity to be involved in Junior School Council for this year. There will also be one student in Grade 3 and 4 involved in JSC as well.

#### End of Year Christmas Concert / Graduation Night 2011



#### **Keyboard and Guitar Lessons for 2012**

Keyboard and guitar lessons began today for interested students. The cost is \$16 per 20 minute session (student will need to have their own guitar for guitar lessons).

For more information please call Cliff Doornkamp ph 58314270 or contact the school.

This year we welcome Katrina Brooks and Clayton Groves (Taylah), Melissa and Dylan Jones (Grace), Melissa and Ashley Robertson (Tayla), Alisha Eastick and Christopher Rumsey (Brock & Taylah – Grade 4) and Belinda and Adam Sprunt (Alicia) into our community and we trust that their time will be both rich and rewarding.

New pupils starting this year are **Jessica Bassett, Nicolas Church, Zoe Collins, Taylah Groves, Grace Jones, Dan Klein, Declan Newbound, Tayla Robertson, Brock Rumsey and Alicia Sprunt (Preps)**. We wish them well in their first year at Tallygaroopna Primary School.

### **1. Prep Information**

Throughout the month of February, children in Prep WILL NOT attend school on Wednesdays. They will remain at home on 8<sup>th</sup>, 15<sup>th</sup>, 22<sup>nd</sup> and the 29<sup>th</sup> February. There may be some Wednesday's where Mrs Wallace may require your child to attend a certain time for specific testing, but she will inform parents of this if there is a need. We will continue to implement a whole school buddy program on Friday afternoons, once every fortnight. The first full week for Preps will begin on Monday 5<sup>th</sup> March.

### **2. Newsletter / Website**

For the information of new parents, please note that newsletters are usually sent home each Monday. Please check your child's bag for these as they contain important information on what is taking place in the school. Any items for the newsletter must reach the office by 9.00am on Monday. The newsletter will also appear on the school website and it will be there each Monday after school. I encourage all families to take a look at this site as it will be constantly evolving over time and many other valuable resources for parents and children are found here. If you would like to receive your newsletter by email instead of a paper copy, please contact Karen at the Office.

### **3. Staffing**

Staffing arrangements for this term are as follows:

Principal - Mr David Brodie	Business Manager - Mrs Karen Armstrong
Prep/1 - Mrs Sandra Wallace	Grade 2/3/4 - Mrs Claire Haberfield
Grade 5/6 - Mr David Brodie	Information Technology (Monday) – Mr David Brodie / Mrs Claire Haberfield
MACC Van (Art) – Mrs Gwen Hack	P.E. (Tuesday) – Mr David Brodie / Mrs Sandra Wallace
MARC Van (Library) – Mrs Robyn Mitchell	Science Specialist – Rosalie Thomas
Keyboard Lessons – Cliff Doornkamp	

### **4. School Fees for 2012**

At School Council last year in December, we discussed School Fees for 2012. These will be the same as last year (\$140). This includes subsidizing school supplies along with many programs which are implemented at school including MACC Van, MARC Van, Mathletics, Reading Eggs, Ziptales, etc. there will be no Excursion Levy included this year. As a result, families will have 2 options – either to pay for excursions throughout the year as they occur or, pay an amount upfront which will be allocated to excursions as they occur. This alteration, will allow families to be able to track what excursions are held and paid for.

Whole School Excursions / Incursions Planned for 2011 – Amounts are Estimations only.

Life Ed. Van-\$8.50

Cluster Days

\* Term 1 – Aquamoves-\$4.00

\* Term 2/3/4 – Cluster Days at other small schools-\$4.50, \$2.00, \$3.00

\* Performance at Wanganui Park SC-\$7.00

\* Athletics Sports-\$5.20

\* Swimming Program-\$45.00

Possible Individual Grade Excursions – Amounts are Estimations only.

Yachting-\$25.00

Kanga 8's Carnival-\$2.00

End of Year Excursion – Whittlesea Fun Fields-\$40.00

### **5. School Assembly**

A school assembly is held each Monday morning beginning at 9.00am. Parents are quite welcome to attend.

## **6. EMA**

The Education Maintenance Allowance (EMA) helps to cover the costs related to your child's schooling. The EMA provides families on a low income with financial assistance to support their child's education up to the age of 16. The allowance is paid in two instalments throughout the year; the first instalment from March onwards and the second instalment from August onwards. Half of the payment is paid to the school and half to the parent or guardian. You need to submit your EMA application to your child's school by **29 February 2012**, in time for the first instalment, or by **3 August 2012** for the second instalment. ***Application forms are available from your child's school.*** If you submitted an application form for the first instalment, and your child has not changed schools since then, you do not need to complete another application form for the second instalment payment. Parents have the option to have their EMA instalments paid by Electronic Funds Transfer (EFT) directly into your bank account. You can select this option when filling in your application form. The EFT payment option has been introduced to offer you a faster and more convenient option for receiving your EMA payment. Choosing the EFT option means that you will receive your payment approximately two weeks sooner than if you choose the cheque payment option.

### **To be eligible for the EMA:**

1. Your child must be under the age of sixteen; **and**
2. Your child must be enrolled at a primary or secondary Government or registered school in Victoria on, **29 February 2012** for the first instalment and **3 August 2012** for the second instalment; **and**
3. You must on **1 February 2012** for the first instalment and **16 July 2012**, for the second instalment:
  - be a parent or legal guardian of the student; **and**
  - be an eligible beneficiary within the meaning of the *State Concessions Act 2004*, that is, a holder of Veterans Affairs Gold Card or be an eligible Health care card (HCC) or Pensioner Concession Card (PCC) holder **or**
  - be a foster parent.
4. Submit your application to the school by the due date:
  - 29 February 2012 for the first instalment\*
  - 3 August 2012 for the second instalment.

\* Please note: you only need to make a second application in August if your child changes schools between March and August.

The Pension Concession Card (PCC) or Health Care Card (HCC) is subject to electronic confirmation with Centrelink to verify that the cardholder is receiving a benefit.

### **Primary students – Payments in 2012**

The total annual combined payment for primary students is \$235 (increased from \$230 in 2011)

Parent portion:

- instalment one \$82.25 (from March 2012)
- instalment two \$35.25 (from August 2012)

The portion that goes to your school will be \$82.25 for instalment one and \$35.25 for instalment two.

## **7. School Times**

The school day commences at 9.00am and concludes at 3.25pm. Recess is from 11.00 – 11.30am and Lunch is from 1.15 – 2.00pm (children eat in classrooms from 1.05 – 1.15pm). We are obliged to give children 5 hours of instruction at school and these specific times cater for this and allow some flexibility with our bus at the end of the day.

### **8. Art / Library Van**

Our MACC and MARC Vans will continue to come to our school on alternative weeks to support our Library and Art Programs at school. Art (MACC) will begin on Friday 10<sup>th</sup> February and Library (MARC) will begin the following week on Thursday 16<sup>th</sup> February. **It would be appreciated if an old shirt could be supplied as an Art Smock if possible. Green bags will be used for borrowing library books.**

### **9. Sun Smart Policy**

Tallygaroopna Primary School endorses a SunSmart policy during Term 1 and Term 4. Students must wear their widebrimmed hat at recess and lunch time. Students without hats must stay in the undercover area between the Multi Purpose Room and the Brick Building. New hats may be purchased from the school at a small cost.

### **10. Religious Education**

Parents wishing to change previous arrangements with their child undertaking RE will need to notify the school. This program is extremely beneficial and links directly into the important school values that we are aiming to get our children to live by (respect, honesty and inclusion). This will be held on a Thursday and is scheduled to begin on 8<sup>th</sup> March.

### **11. Lunch Orders - Friday**

These will begin this Friday 10<sup>th</sup> February. Information is included in this edition in the newsletter. Lunch Orders will need to be in at school by 11am.

### **12. Term Dates**

Over the next few weeks, I will continue to update this section. Confirmed dates for TERM 1 are:

February 7 <sup>th</sup> – Tallygaroopna Steering Committee Mtg.	February 10 <sup>th</sup> – Art Begins (MACC Van)
February 13 <sup>th</sup> – AASC Program Begins	February 15 <sup>th</sup> – Meet and Greet Information Night
February 16 <sup>th</sup> – Library Begins (MARC Van)	February 22 <sup>nd</sup> – School Council & Finance
February 29 <sup>th</sup> – Responsible Pet Program	March 1 <sup>st</sup> – Cluster Day (Aquamoves)
March 6 <sup>th</sup> – World Spelling Day	March 7 <sup>th</sup> – World Maths Day
March 7 <sup>th</sup> – Late Newsletter	March 8 <sup>th</sup> – World Science Day
March 8 <sup>th</sup> – Religious Education Begins	March 12 <sup>th</sup> – Labour Day Holiday
March 19 <sup>th</sup> – Curriculum Day (no students)	March 21 <sup>st</sup> – School Council & Finance
March 27 <sup>th</sup> – Athletic Sports – McEwen Reserve	March 28 <sup>th</sup> – Athletic Sports Back Up Day
March 30 <sup>th</sup> – Term 1 Finishes – 2.25pm	

### **13. The Ultranet**

We managed to bring all of our students online with the Ultranet last year. Students will be utilising this resource in and out of the classroom over the next few months and their new learning goals should be online soon. If parents need any assistance getting online could they contact David at school ASAP. There have been a few small issues with this resource and we will endeavour to assist if there is a need. New Welcome Letters will be given to new parents as soon as possible. New Preps will be able to access this site soon.

<https://ultranet.vic.edu.au>

<http://www.education.vic.gov.au/about/directions/ultranet/default.htm>

### **14. Book Club**

Book Club booklets went home with students today. If you would like to make an order, fill out the order form at the back of the booklet complete with your child's name and return to school with payment (make cheques payable to Tallygaroopna Primary School) by Friday 10<sup>th</sup> February.

### **15. Payment Envelopes**

Specially printed envelopes have been sent home with the students today. When sending money to school, please seal it in the envelope, fill out the details on the front of the envelope and post it in the green box inside the office door.

### **16. Tallygaroopna Steering Group**

This year is an exciting time for the township of Tallygaroopna with the Greater Shepparton City Council developing a community plan. **If you would like to be involved in this process and perhaps be on a steering committee a meeting will be held at school tomorrow night at 7.30pm.** Michelle Patterson who is a Strategic Planner is assisting with this along with a consultant. Past community plans can be viewed at the link below.

[http://www.greatershepparton.com.au/council/buildingplanning/planning/strategic\\_planning/currentstrategicprojects/communityplans/](http://www.greatershepparton.com.au/council/buildingplanning/planning/strategic_planning/currentstrategicprojects/communityplans/)



### **17. Medicine at School**

For those students required to have medication whilst at school, a Medication Request Form is required to be filled out, signed and returned to the school office prior to the student be administered medication. A form is attached to this newsletter. Further copies are available at the Office. This does not apply to children with asthma with their puffer, although the office must be informed of the child's needs in this regard. Any change to the child's medical condition should be relayed to the office ASAP.

### **18. Headlice**

Please be vigilant in checking your child's hair for lice. We were relatively 'lice-free' last year and would like to continue in this vein this year. Thanks for your cooperation.

### **19. Frozen Fruit Freezes**

Frozen fruit sticks will be available for sale each Friday at lunchtime for 50 cents each.

### **20. Kids & Fruit**

Kids and Fruit is once again offering our students the opportunity to enjoy fresh and tasty fruit and vegetables 5 days a week. Cost will be \$10 per term. Please complete the form and return to school with the money by this Thursday morning, 9th February. The program will start next Monday, 13th February.

Kids & Fruit Program Term 1 – 2012

Students Name	Class	Comments/Allergies

NB# From time to time, Kids & Fruit Inc. will introduce new fruit and vegetable varieties to the program and therefore it is imperative that you inform the school of any allergies your child suffers which will be forwarded onto Kids & Fruit Inc. (eg. allergy to citrus fruit or strawberries). If a fruit or vegetable is provided that your child is allergic to, Kids & Fruit will compensate accordingly.

### **21. Fruit in Classrooms**

This year, all classrooms will be having a fruit/vegetable break at 10.00am each morning. Students are asked to bring along a piece of fruit/vegetable to eat at this time. Students involved in the Kids and Fruit program will be given their fruit at this time. There will still be the usual play lunch at recess time.

### **22. Conveyance Allowance**

To be eligible to receive conveyance allowance, a student must:

- Be aged between 5 years by the 30<sup>th</sup> April and 21 years;
- Live more than 4.8 km by the shortest practicable route from the nearest school attended.
- Be enrolled at the nearest government primary school.
- Have NO access to bus travel

Those people eligible need to obtain an application form from the office and return it to school by the 17<sup>th</sup> of February.

### **23. Uniform Order**

Attached to this newsletter is a uniform order form. **If you would like to make an order, please fill out the form and return it with payment (cheque to be made payable to Tallygaroopna Primary School) by this Friday, 10<sup>th</sup> February.**

### **24. Parents Club**

A big thank you to the Parents' Club for organising the Morning Tea last Thursday. It was a great idea and it was terrific to see so many families attend the first assembly for the year. New and existing parents are always welcome to join this club which constantly supports the school. Last year some great fundraising occurred (Pie and Chocolate Drives, School Fete, Recipe Book) and the school was able to purchase a new marquee as a result of this.

## **25. Student Information**

Over the next week we will be sending home data indicating general information about each student currently held on Cases21 at the school. Could you please check, update if required, sign the forms and return them to school as soon as possible so that we can update our data base.

## **26. AASC Program**

We will be starting our Active After-school Program next week. We will be offering Aerobics on a Monday (starting next Monday 13th February) and Hockey on a Tuesday (starting next Tuesday 14th February). Both sessions will start at 3.35pm and finish at 4.35pm. Participating students will be given fruit for afternoon tea prior to the start of each session. If your child/ren are interested, please fill out the attached form and return to school by this Friday, 10th February. Andrea Walker will be our school supervisor on Monday's and Jill McFarlane will fulfil this role on a Tuesday. Unfortunately, no vouchers will be available at present as participation awards.

## **27. School Council**

The first school council meeting for the year will be Wednesday, 22<sup>nd</sup> February at 7.30pm. The Finance Committee will meet beforehand at 6.30pm. **This year, there will be a couple of positions available for parents to be a member of school council. If anyone is interested in being part of School Council for 2012 could you contact David at school.**

## **28. Personal Property**

Personal property is often brought to school by students, staff and visitors. This can include mobile phones, calculators, toys, sporting equipment and cars parked on school premises. The Department of Education and Early Child Development does not hold insurance for personal property brought to schools and it has no capacity to pay for any loss or damage to school property. Therefore, staff, students, parents and guardians should be discouraged from bringing any unnecessary or particularly valuable items to school.

## **29. School Photos**

The 2012 School Photos will not be taken until Friday 4<sup>th</sup> May in the morning. This is a little later than normal and more information will be available early in Term 2.

## **30. Information Evening**

An Information and Meet the Teachers evening will be held at school on Wednesday, 15th February from 5.30pm - 6.30pm. At 6pm Mrs Wallace will speak to Prep/1 families for approximately 30 minutes. This year there will be no evening meal as we have found that very few families have made use of this facility in recent years.

## **31. Homework**

Homework is an opportunity for parents or carers to participate in their child's education. Homework complements and reinforces classroom learning, and fosters good lifelong study habits. We acknowledge that families have busy lives but all we are asking for as staff at Tallygaroopna PS is a minimum of 30 minutes a week along with nightly reading. Spelling and tables may be implemented by classroom teachers on top of this. As staff, we will accept notes by families if homework is unfinished, as long as this is not a regular occurrence. Homework will be handed out **early in the week** and will be expected to be returned and completed by Friday.

To support students at our school we will open a Homework Club on Fridays for anyone who is having trouble with homework. This will be from 1.15pm – 1.45pm in the Project Room.

Parents can help children by:

- encouraging a regular daily session to examine and complete homework
- discussing key questions or suggesting resources to help with homework
- helping to balance the amount of time spent between homework and recreational activities such as watching television or playing computer games
- asking how homework and class work is progressing, and acknowledging success
- talking to teachers to discuss problems with homework
- for upper primary and secondary students, checking whether homework has been set and ensuring that their child keeps a homework diary
- reading texts set by teachers and discussing their child's responses to set texts and asking to see work they complete in relation to these texts

### **32. Mathletics / Ziptales**

Our school has again invested in these two great educational programs which are available for student use at home and at school. Passwords will be sent home with parents for these as soon as possible.

<http://www.mathletics.com.au/>

<http://www.ziptales.com/>

This year, we are investing in Reading Eggs as a whole school also. More specific information will be available next week. The Junior students utilised this website last year and it has been expanded to include senior students for 2012.

### **33. I.T. – Acceptable Use**

This week, all families will receive information in regard to acceptable use with the Ultraset, Internet and other Digital Technologies. Although, there is a lot of information in this document, page 2 is all that is needed to be returned to school. Could this be done by Monday 13th February please.

### **34. Engagement Policy**

All families will receive the schools revised Engagement Policy which includes our current school values. This document was approved in 2010 and it is a living and breathing document so new additions / alterations may occur throughout the year. Could parents return the last page of this document to the office by Monday 13th February please.

### **35. You Can Do It**

This year, all classes will deliver the You Can Do It Program in a more formal manner. Lessons will be conducted on a regular basis during the week and will focus on the 5 keys which are: Confidence (academic, social), Persistence, Organisation, Getting Along and Resilience. The Core Purpose of this program is aimed at the development of young people's social and emotional capabilities.

### **36. School Bus / Safety**

All families should have received information about the School Bus for 2012. Could information regarding Safe Travel and Bus Rules please be returned to the school office by Friday 10th February please.

It is imperative that families who have children who are bus travellers contact the school if their children are not going on the bus in the afternoon. This will enable the bus to keep to the scheduled times. Mrs Haberfield will be the school contact for buses in the afternoon and parents will need to make contact with her using either notes or phoning the school. Alternatively, parents can text message Mrs Haberfield on 0400 879 206 but please DO NOT ring her mobile during class time. There has been some confusion in the past, so could parents contact the school to confirm specific days which children use the bus please.

### **37. English Online Interview**

The English Online Interview is a powerful online tool for assessing the English skills of students in Years Prep to 2 in Victorian government schools. The Interview assesses students across the three dimensions of the English domain of the Victorian Essential Learning Standards (VELS) – Reading, Writing and Speaking and Listening. Teachers will be conducting these tests over the next few weeks. It is compulsory to conduct these with Prep students and we will be endeavouring to complete them with students in Grade 1 and 2 also.

<http://www.education.vic.gov.au/studentlearning/teachingresources/english/englishonline/default.htm>

### **38. School Values**

These values are used to support our students, teachers and parents in becoming positive citizens within their community.

- Inclusion: including others and to not leave anyone out. It is important to let people join in if they are not playing with anyone and to involve others in decision making so that everyone gets a say.
- Respect: being nice to others and to treat others how you would like to be treated. If you show respect you look after property that belongs to individuals and consider other peoples thoughts and opinions. Respect also involves being considerate of differences and personal space.
- Honesty: tell the truth and own up to things in a mature manner. Individuals who are honest don't lie and always strive for their best without settling for second best.



### **39. Soccer Teams**

Any children wishing to play soccer this year with Northerners Soccer Club can leave their names at the office. More information will be available soon.

### **40. Zone Sport**

Zone Swimming and Tennis Trials are coming up soon. If anyone is interested in these could they see Mr Brodie ASAP.

#### **Kindergarten & Fun Group Enrolments 2012**

If you have a child or know of a child who would be interested in attending Kindergarten or Fun Group for 2012 @ Tallygaroopna Children's Centre.

Please enquire @ the centre on ph; 58298274

#### **Tallygaroopna Primary School Recipe Books**

These can still be purchased from the School Office at \$12 each.

**STUDENT OF THE WEEK WILL START ON MONDAY 13<sup>TH</sup> FEBRUARY.  
UNFORTUNATELY, NO COLLINS BOOKSELLERS (BOOK CITY) VOUCHERS WILL  
BE AVAILABLE AT PRESENT. WE WILL HAND OUT AN ICY POLE VOUCHER.**

**STUDENTS ARE ABLE TO ACCESS SUNCREAM ON A REGULAR BASIS IF  
NEEDED. THIS SITS ON THE TABLE NEAR THE SINK IN THE PROJECT ROOM.**

**ONCE A WEEK, WE WILL BE SOUNDING OUR 2 ALARMS TO ALLOW STUDENTS  
TO BECOME AWARE OF THESE IF THE NEED ARISES IN THE CASE OF AN  
EMERGENCY.**

### **Asthma**

School Asthma Action Plan forms have been sent home to families with students with asthma. Could these forms be completed and signed as soon as possible and returned to school. This is to ensure that the school has the student's most recent Action Plan on file.

### **Confidential Student Information**

A green Confidential Student Information form has been sent home to each family today. This form acts as a quick reference for the staff on excursions and ensures that the school has up-to-date information and signatures for a variety of issues and programs. Could this form please be filled out (please ensure both sides have been completed) and returned to the school Office as soon as possible.

**BACK TO SCHOOL 2012**  
**Reducing the risk of an asthma attack in February:**  
**Tips for Parents & Carers**

**What is the February asthma spike?**

Throughout the year there are significant increases, or 'spikes', in asthma presentations to hospitals and emergency departments<sup>1</sup>. Approximately 1 in 9 children in Australia have asthma, and for children and adolescents with asthma these 'spikes' usually occur towards the end of holiday periods as they return to school and preschool<sup>2</sup>. A significant 'spike' in asthma symptoms, and subsequent hospital admissions, of children and adolescents occurs throughout the first few weeks of February<sup>3</sup>. The following are key points that are important for parents and carers of children or teenagers to be aware of.

**Why does the spike occur?**

While there have not been direct links established, the February 'asthma spike' is believed to be largely due to children and adolescents coming into contact with asthma triggers that they have had time away from, as they are now returning to school.

**Triggers that can be encountered are:**

- Dust and mould spores from poorly ventilated, or insufficiently cleaned school/preschool rooms
- Respiratory viruses, such as cold and flu viruses
- Cleaning products that leave behind strong smells, aerosols or airborne dust
- Anxiety and stress due to returning to school/preschool

**What can parents and carers do to avoid asthma exacerbations at school?**

- Ensure your child is always carrying their reliever medication (e.g. *Ventolin*, *Asmol*, *Airomir* and *Bricanyl*) as well as a spacer. If required, also ensure that you provide medication to the preschool your child attends
- Ensure that you have provided your child's school/preschool with an updated Asthma Action Plan
- Ensure that your child or teenager knows how to recognise early symptoms of an asthma attack and know to use their reliever medication properly
- Ensure your child or teenager will seek help from school/preschool staff if they experience asthma symptoms
- Ensure that your child or teenager's asthma is being well managed and that their medication and management is reviewed annually by your GP (this is a good opportunity to also update the Asthma Action Plan)

<sup>1</sup> Australian Centre for Asthma Monitoring (2011), "Asthma in Australia: with a focus chapter on chronic obstructive pulmonary disease", Australian Institute of Health and Welfare, Canberra 2011.

<sup>2</sup> Ibid.

<sup>3</sup> Ibid.

## Positive Parenting Program



Parents and carers of children aged 2 to 10 years are invited to participate in a Positive Parenting Program.

At times we are all challenged in our role as parents. Come and join the group and share some strategies to help build strong healthy families and enhance your relationship with your children. The program will be run as 4 sessions and will take place once a week for 4 weeks on a Tuesday evening.

### Topics include:

- Building positive relationships
- Teaching new skills and promoting positive behaviour
- Managing misbehaviour
- Planning ahead/family survival tips
- Parent self care
- Individual parenting strategies.

**Venue:** Primary Care Connect  
(formerly Goulburn Valley Community Health Service)  
399 Wyndham Street Shepparton.

**Starting Date:** Tuesday 21<sup>st</sup> February 2012

**Time:** 7.00-9.30pm

**Cost:** \$25.00 per person / \$30.00 per couple

(This covers the cost of one workbook and light refreshments)

**Facilitator:** Gillian Bliss

**Bookings are essential as places are limited**

**To Book and for more information:** Contact Claire Walsh at  
Primary Care Connect. Telephone: 58 233 200



Brought to you by Hume Region Parent Education Service



## Mathletics 2011

# Tallygaroopna Primary School

January – November

## Improvement and Usage Report

During 2011, 50 students from Tallygaroopna Primary School used Mathletics to support learning in maths. We recorded the score each student gained after first completing an activity and measured it against subsequent scores achieved after completing that same activity. Each time an activity is attempted a different set of questions is presented to students.

### Overall School Usage Results

Category	Result
Live Mathletics Correct Answers	142665
Full Curriculum Correct Answers	34658
Participation Certificates	188
Total Star Improvers*	521
Average 1st Attempt	73%
Average Final Attempt	96%
Average Improvement	32%

\*A Star Improver is a student who has made significant improvement (more than 10%) on a particular activity.

### Top Five Concept Masters

Student Name	Teacher Name	Concepts Attempted	Concepts Mastered	% Concepts Mastered
Kyle Montgomery	Sandra Wallace	119	113	94%
Kaleb Oxley	Ella Bioknell	100	83	83%
Jordan O'Brien	Claire Haberfield	84	82	100%
Campbell Steigenberger	Sandra Wallace	83	71	85%
Abby Klein	Claire Haberfield	63	62	98%

# Canteen Price List (Tally Take Away – Ph. 58298252)

## Information:

- Lunch Orders will be available in Terms 1 and 4 only. The first canteen order will be available this Friday 10<sup>th</sup> Feb.
- Lunch Orders will be picked up at 11am and delivered to the school at 1pm.
- All Lunch Orders should be written on an envelope with Name and Grade. These should be itemised with the amounts. Families can use any envelope which is suitable
- Correct change is not essential – however, this would be one less thing that the school would need to worry about.

# TALLY TAKE AWAY

## SCHOOL MENU AND PRICE LIST

### Sandwiches and Rolls

Ham, Chicken	\$3.00
Salad Only (tomato, cheese, beetroot, lettuce, carrot)	\$3.50
Meat & Salad	\$4.00
Cheese or Vegemite	\$2.50

### Hot Food

Chicken-Gravy Roll	\$3.50
Pie, Pastie, Sausage Roll	\$3.00
Sauce extra	\$0.20
Hot Dog & Sauce	\$3.50
Toasted Ham & Cheese sandwich	\$3.50
Dim Sims (fried or steamed)	\$0.80

### Hot Snack Food

Chicken Nuggets	\$0.50
Hot Chips	\$2.00

### Drinks

Water	\$2.00
Prima (orange, tropical)	\$1.50
Big M - Small (choc, strawberry)	\$2.40

