

# TALLYGAROPNA PRIMARY SCHOOL NO.3067

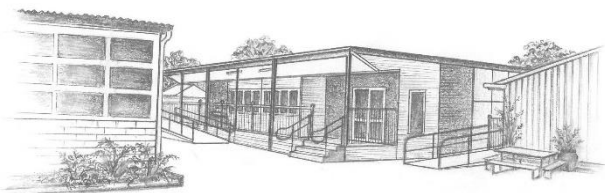

TERM 2 NO. 17 6<sup>th</sup> June 2022

Victoria Street, Tallygaroopna

Phone 03 58298264

Fax 03 58298244

[tallygaroopna.ps@education.vic.gov.au](mailto:tallygaroopna.ps@education.vic.gov.au)

Website - <http://www.tally-ps-3067.vic.edu.au/>

Mobile 0411 960 164

Facebook Page - [Click here](#)

Small Schools Website - [Click here](#)

**SCHOOL VALUES - RESPECT, HONESTY & INCLUSION**

## News from the Principal's Desk

Hi everyone

It was pleasing to see more students at our school last week and hopefully those that have recovered from various illnesses stay healthy for many weeks to come. Obviously, sickness is unavoidable and we thank all of those parents and carers for doing the right thing by keeping unwell children home. During the last few weeks, we have also had some unwell staff – we will endeavour to continue to navigate through this difficult time as best as we can.

Unfortunately, we had to cancel Munch N Crunch this week because of the lack of helpers on Thursday. Please offer to help out if you can in the future, so that our children can benefit from some things that are organised by the Parents' Club. This group is only small in nature, but hard working – the next meeting will be held on Monday 25<sup>th</sup> July and we hope some new faces come along on this afternoon.

Reports are not far away and staff are busily trying to finalise these so they go home before the holiday break. We are aiming to also update student goals which will go home in sealed envelopes as well – don't hesitate to contact any members of staff if any information in these reports needs to be clarified. An enormous amount of time and effort goes into these reports and we hope you find these a good reflection of your child's performance in Semester 1.

We had to address absence notifications on Skool Loop last week. Please be specific in regard to why your child is away from school. This may include such things as: medical, illness, COVID-19, appointments, family holidays and bereavements / funerals. The Education Department mandates that schools must record student attendance twice per day giving suitable reasons for each absence. This is necessary for schools to meet their legislative requirements and to enable school councils to report on student attendance annually. Your assistance in this matter would be greatly appreciated. Finally, we are still looking for helpers with the Bunnings BBQ this Sunday and **I would encourage any families who don't get an opportunity to help out throughout the year to put their hand up and offer to do a 2 hour block assisting with this fundraiser.** The date may not be ideal, but we obviously cannot knock back this opportunity which allows us to generate some great funds into the school. As always, this will be used for buildings and ground – probably some more soft fall for our playgrounds to ensure that our children are safe. Thanks to the couple of families who have donated some water and soft drink so far – your support is greatly appreciated. Karen will be at the school all week to attend to any matters that arise. I look forward to seeing some parents throughout the week. Don't forget that students are not required at school on Friday 10<sup>th</sup> June – there is no OSH Care also so families will need to make alternative arrangements. Plenty of notice has been given to assist with this.

David Brodie (Principal)

I will be away on Tuesday unfortunately.

**ALTHOUGH FACE MASKS ARE NO LONGER REQUIRED FOR STAFF AND GRADE 3-6 STUDENTS INDOORS - STAFF WILL BE WEARING THESE FOR THE TIME BEING CONSIDERING THE ILLNESS THAT HAS BEEN ACROSS THE SCHOOL AT PRESENT.**

**CAN ANY OUTSTANDING PAYMENTS BE PAID FOR PLEASE BY THE END OF THE WEEK IF POSSIBLE. THIS MAY INCLUDE SUCH THINGS AS THE LIFE ED VAN (F-6: \$8) AND CROSS COUNTRY (3-6: \$2)**

**WE ARE URGENTLY AFTER SOME HELPERS FOR THE BUNNINGS BBQ ON SUNDAY 12<sup>TH</sup> JUNE. IF YOU CAN ASSIST AND DO A 2 HOUR BLOCK CONTACT THE SCHOOL ASAP.**

**Students and staff who have tested positive for COVID-19 and have completed their 7-day isolation period, now do not need to undertake screening for 12 weeks if they are asymptomatic.**

**PERMISSION FORMS DUE NOW WITH PAYMENT PLEASE:**

**Kyabram Fauna Park - \$15**

**CURRICULUM DAY – FRIDAY 10<sup>TH</sup> JUNE (NO SCHOOL OR OSH CARE)**

**QUEENS BIRTHDAY HOLIDAY:  
MONDAY 13<sup>TH</sup> JUNE (SCHOOL RESUMES ON TUESDAY 14<sup>TH</sup> JUNE)**

**DIRECT BANK DEPOSIT**

Account Name:

Tallygaroopna Primary School

BSB: 063—527

Account number: 0090 7788

**Please ensure you include family name and payment description as reference.**



How is **YOUR** head today?  
What **THOUGHTS** are taking  
up most of your  
headspace?  
It's okay not to be **OKAY**.  
Remember, **HELP** is just a  
phone call away.



An initiative of the Goulburn Health & Wellbeing Project



### Facebook a Reminder

Just a friendly reminder not to post photos of students that you have taken at school events on your own Facebook page, without notifying the child's parent first. Thank you for your ongoing support with this.



Student accident insurance, ambulance cover arrangements and private property brought to school.

A reminder that Schools do not provide personal accident insurance or ambulance cover for students. Parents and guardians of students, who do not have student accident insurance/ambulance cover, are responsible for paying the cost of medical treatment for injured students, including the cost of ambulance attendance or transport as well as any other transport costs.

Private property brought to school by students or visitors is not insured and the Department does not accept any responsibility for loss or damage.

# TALLYGAROPNA PRIMARY SCHOOL NO.3067



Victoria Street, Tallygaropna

Phone 03 58298264

Fax 03 58298244

[tallygaropna.ps@education.vic.gov.au](mailto:tallygaropna.ps@education.vic.gov.au)

Website - <http://www.tally-ps-3067.vic.edu.au/> Mobile 0411960164

**SCHOOL VALUES - RESPECT, HONESTY & INCLUSION**

Dear parents and carers

I am writing to inform you about the impact of influenza (flu) among our school community and measures we can all take to reduce the spread of flu as we enter into the colder months.

I want to reassure you that we are taking this very seriously and continue to follow the expert advice of the Department of Education and Training and Department of Health, to help ensure that our school continues to run effectively.

To help protect our school and the wider community, we ask that unwell students stay home, given the impacts of flu and colds on our school community.

To help reduce the spread of flu, colds and COVID-19, students are being encouraged to;

- wash and sanitise their hands regularly
- avoid touching their eyes, nose, and mouth with unwashed hands
- cover their nose and mouth when they cough or sneeze
- get tested for COVID-19 if they feel unwell and follow the current [Department of Health isolation requirements](#) if a positive result is shown
- if unwell, stay at home until their symptoms pass.

Face masks are available in all schools and can be worn by any staff or students who wish to do so, including those who are medically at risk.

Vaccination remains the best protection against both COVID-19 and flu, and we encourage you to get your child vaccinated. Flu vaccinations can be booked through GPs and pharmacies, many of which can also provide COVID-19 vaccinations.

Please see the [letter from the Royal Australian College of General Practitioners](#), Victoria Faculty Council Chair, about the importance of protecting your children and family.

If your child does become sick while at school, please also ensure that we have correct emergency contact details for yourself. This is so we can get hold of you as quickly as possible.

I am aware that this is a challenging situation and we thank you for your understanding and support at this time.

If you have questions about what this means for our school, please feel free to contact me on 58298264.

Thank you again for your support.

Yours sincerely

David Brodie

Principal - Tallygaropna PS



2023

# Three and Four-Year-Old Kindergarten Registrations **NOW OPEN**

**REGISTER ONLINE**



Scan the QR code or go to  
[bit.ly/2023KinderReg](https://bit.ly/2023KinderReg)  
to complete the online registration form  
[greater-shepparton.com.au](https://greater-shepparton.com.au)

# Phys Ed Report – Term 2



This term in Physical Education we have been learning a little bit about the sport of **Hockey**.

Hockey is a term used to describe various types of both summer and winter sports which can be played either on an outdoor field, sheet of ice or dry floor such as a stadium. Most students were aware of the Ice Hockey version having seen it on television at some stage.

Two teams play against each other by trying to manoeuvre the ball or a disk (puck) into a goal using a hockey stick. The team is made up of ten players and a goalie (Field Hockey).

**Some rules of the game** – must use flat side of the hockey stick, no high back swing, cannot kick or use hands to touch the ball, only two players can battle for the ball.

Shepparton has a synthetic hockey field at the Greater Shepparton Regional Sports Precinct. Shepparton is home to some great hockey players including Louise Dobson who played in the 1996 Atlanta Olympic Games, winning gold. Mathew Higgins is another local who was recently inducted into the Greater Shepparton Hall of Fame for his contribution to the game of hockey. Connor Holland is also another young local who was inducted into the junior honour roll because of his involvement in hockey, keep an eye on this young fella, he may play for Australia one day!

*We have enjoyed a few weeks of learning some of the skills required to play hockey: passing, shooting, stickhandling, dribbling and trapping (stopping the ball). We have used a real wooden hockey stick during the skills session and have then swapped over to a plastic version (to eliminate injuries !!!!) when we played a modified game of hockey, trying to pass the ball to team mates and ultimately score a goal.*



## PHOTOS OF THE WEEK – PAWS IN SCHOOLS (GRADE 3/4)



## Ration Challenge 2022

Last year, the 5/6 class had the opportunity to participate in the Ration Challenge and this year we have decided to take part again!

In the last week of Term 2, lots of the 5/6 students (plus some parents and staff) will be taking on the Ration Challenge and eating only rations for a three day period. This experience is designed to emphasise the hunger experienced by so many and to develop empathy for others.

From 3pm today (Friday June 3rd) until 9am on Monday June 6th, all donations to the Ration Challenge will be matched by the organisation's partners.

So far our team has raised over \$400 to support refugees.

If you would like to assist with our fundraising efforts, please visit our team page:  
<https://schools.rationchallenge.org.au/t/5-6-1>

Miss Lothian

# ENCHANTED FOREST OF PROTECTION



## COVID-19 vaccinations for children are available

Your local community has upcoming COVID-19 vaccination clinics at:

### Grahamvale Primary School

**Where:** 85 Grahamvale Rd, Grahamvale

**When:** 9am – 1pm on Wednesday 8 June 2022

*This clinic is accessible to people with a disability.*

### Tatura Primary School

**Where:** 33 Service St, Tatura

**When:** 2pm – 6pm on Wednesday 8 June 2022

*This clinic is accessible to people with a disability.*

**Vaccinations are also available for adults at all clinics.**

**Just walk in, no booking required.**



## **COMMUNITY GIVEBACKS PROGRAM – REBEL SPORT IN SHEPPARTON**

*We are proudly partnering with rebel in their rebel Community Givebacks program which entitles our school to receive 5% of all our members purchases at rebel back as credit to spend instore on sports equipment or teamwear! To support our school all you need to do is join the rebel active loyalty program and link your member account to our school next time you visit your local rebel store. A friendly team member can help you do this instore and you'll also receive some great benefits like exclusive member offers and access to VIP experiences, rewards and competitions for being a rebel active member.*

*Just remember to swipe your rebel active loyalty card instore or log into your account online when making a purchase at rebel and our school will receive 5% back as credit to spend on sports gear!*

*Thanks for your support.*

### **COMMON QUESTIONS**

#### **How does my sports club or school start earning credits?**

- Your members or students need to sign up to be a rebel active member instore or online at [www.rebelsport.com.au/account/register](http://www.rebelsport.com.au/account/register) and head into their local store to link their account to your sports club or school.
- If your members or students are already a rebel active member, they simply need to head into store to link their account to your club or school.
- We recommend you regularly communicate the benefits of the program to your members or students to ensure they sign up and link their rebel active account to your club or school.

#### **How do my members benefit?**

- By joining rebel active, your members or students will enjoy a range of great benefits such as exclusive member offers and access to VIP experiences, rewards and competitions.
- In addition, when your members or students link their rebel active loyalty membership to your sports club or school, this will ensure that EVERY dollar they spend at rebel is helping to support your sports club or school!

**rebel**

1/02/2020 - V.1

### **When can my members choose to support our sports club or school?**

- Members or students can join rebel active at any time, however they will only be able to nominate their sports club or school (instore only) once your sports club or school has registered for the rebel Community Givebacks program.

## **GREATER SHEPPARTON SECONDARY COLLEGE TOURS**

**- Each Friday for the rest of Term Two**

Dear Primary Schools,

Greater Shepparton Secondary College are pleased to announce we are offering college tours for families every Friday for the remainder of the term – commencing tomorrow 27th May.

Make a booking using this link: <https://compasstix.com/e/c2gi9ybabi>

Any questions regarding tours or transition please contact Jennifer Attard on 58921000.

## Year 6 to Year 7 Placement Timeline for Parents/Carers

### Statewide placement timeline and procedures for 2022-23

2022 Dates	Activity
<b>Term 2: Tuesday 26 April 2022 – Friday 24 June 2022</b>	
<b>From Week 1, Term 2 2022</b>	Government primary schools distribute information to all parents/carers of Year 6 students on how to access the <b>Placement Information Pack</b> . This pack includes the <i>Application for Year 7 Placement 2023</i> form.
<b>Friday 13 May 2022</b>	Parents/carers return the <i>Application for Year 7 Placement 2023</i> form to their child's government primary school by this date.
<b>Term 3: Monday 11 July 2022 – Friday 16 September 2022</b>	
<b>Wednesday 20 July 2022</b>	Government primary schools notify parents/carers of Year 6 students, in writing, of Year 7 placement offers. The letter of offer will include a <b>Year 7 Placement Acceptance Slip</b> to be returned by the parent/carer, to their child's government primary school by Wednesday 10 August 2022.
<b>From Thursday 21 July 2022</b>	Parents/carers may commence lodging written non-placement appeals to their preferred secondary school using the <b>Year 6 to Year 7 Placement Appeal Form</b> . Your child's primary school will provide you with this form.
<b>Friday 29 July 2022</b>	<b>Closing date</b> for parents/carers to lodge a written non-placement appeal with their preferred secondary school.
<b>Tuesday 9 August 2022</b>	Secondary schools notify all parents/carers in writing of the outcome of their non-placement appeal by this date. <b>Note:</b> If your appeal to your preferred secondary school is unsuccessful, you may lodge a further written appeal to the relevant Department of Education Regional Director. Please see the <b>FAQ</b> on the following pages for more information regarding appeals.
<b>Wednesday 10 August 2022</b>	Parents/carers return their Year 7 Placement Acceptance Slip to their child's government primary school by this date.
<b>Tuesday 23 August 2022</b>	<b>Closing date</b> for parents/carers to lodge a written non-placement appeal with the relevant Regional Director where they are unsuccessful with their appeal to their preferred secondary school.
<b>Term 4: Monday 3 October 2022 – Tuesday 20 December 2022</b>	
<b>Friday 21 October 2022</b>	Regions notify all parents/carers in writing of the outcome of Regional Director non-placement appeals by this date. <b>Note:</b> this only applies to appeals received by the closing date of Tuesday 23 August 2022.
<b>Tuesday 13 December 2022</b>	Secondary schools host an Orientation Day for all Year 6 students.

4



STAY | HOME | STAY | SAFE | SAVE | LIVES

For all current restrictions visit [vic.gov.au/CORONAVIRUS](https://vic.gov.au/CORONAVIRUS)  
Authorised and published by the Victorian Government, 1 Treasury Place, Melbourne.

The Child Safe Standards are compulsory minimum standards for all Victorian early childhood services and schools, to ensure they are well prepared to protect children from abuse and neglect. The standards provide a framework for schools to review existing policies and practices and all other aspects of child safety, to ensure a 'zero tolerance' approach to any form of child abuse. You can access our policy on the school's website.

### Fairleys Supa IGA Community Rewards Program

Our school is registered for the Fairleys Supa IGA Community Rewards program. Families can register in-store. Funds generated by customer point donations are converted to cash and handed over at the end of the financial year.

**Introducing**  
**FAIRLEYS SUPA IGA** **Community REWARDS**  
 FUNDRAISING PROGRAM

**Please Help Financially Support Your School... Join Today!**



[fairleysiga.com.au](http://fairleysiga.com.au)

TALLYGARoopNA P.S.

proud partners of



### SUPPORT OUR SCHOOL

Thanks to our partnership with rebel Community Givebacks  
 5% of what you spend at rebel comes back to us to spend on sports equipment and teamwear.

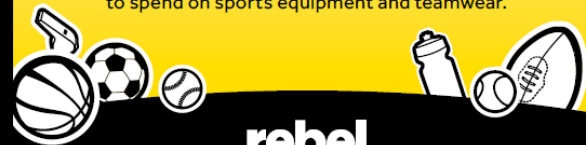

**rebel**

Simply link your **rebel active membership** to our club next time you shop at rebel

Not a member? Joining is free & easy. Ask instore for details.

We are

**eSmart**<sup>®</sup>



**Open Days for 2022: For prospective 2023 families**

Tallygaroopna PS

Tuesday 3<sup>rd</sup> May

Monday 9<sup>th</sup> May

Wednesday 25<sup>th</sup> May

Wednesday 1<sup>st</sup> June

Thursday 9<sup>th</sup> June

Friday 17<sup>th</sup> June

Thursday 23<sup>rd</sup> June



**Your Local Neighbourhood School**

*State Schools are Great Schools* and the schools in the Shepparton Network work together to ensure that your child will receive the same high level of learning and support at each and every school. All students are entitled to attend their closest local school and it is the strong opinion of Principals that your closest school is the best school for you.

In exceptional circumstances, an alternative school may be appropriate. You may be able to enrol in a school that is not your designated neighbourhood school. In this situation, please meet with your local Principal to discuss your schooling options.

To find your designated neighbourhood school, please go to:

<https://www.findmyschool.vic.gov.au/>

School information can be found on our website:

<https://www.tally-ps-3067.vic.edu.au/>

Virtual School Tour: <https://www.tally-ps-3067.vic.edu.au/page/178>

Tours of the school available from 9.30am until 10.30am

School packages are available on the day.

These include enrolment forms, information booklets...etc

Come along and have an informal chat with staff, a cuppa and some morning tea.





Phone 58298264 for more information

– other days can be organised upon request.

## STUDENTS OF THE WEEK

### – Term 2 / Week 5

All students received a certificate and a free icy pole voucher.

<p><b>Foundation - Mrs H's Super Friends</b> <b>Izzi</b></p> 	<p>Izzi received this award for the fantastic way she is so enthusiastic at school. Not only in the classroom where she always tries her hardest but also out in the yard where she happily plays with everyone. Great effort, Izzi.</p>
<p><b>Grade 1/2 – Miss P's Persistent Poppets</b> <b>Eddie</b></p> 	<p>Eddie has been a fantastic role model for his peers this week. He has been extremely helpful and kind to other students. I am so proud of the growth he has shown both socially and emotionally.</p>
<p><b>Grade 3/4 - Miss R's Thriving 3/4s</b> <b>Dan</b></p> 	<p>Dan received this award for being a reliable, responsible and friendly class member. I love the way that Dan is willing to lend a hand to anybody who may need it and he always strives to do his very best! Dan is somebody who I can trust to do the right thing and he consistently demonstrates our school values - respect, honesty and inclusion. Well done, Dan!</p>
<p><b>Grade 5/6 – Miss L's Lively Leopards</b> <b>Kaedyn</b></p> 	<p>Kaedyn received this award for his brilliant effort in the classroom. I have been very impressed by Kaedyn's input during class discussions and the mature vocabulary and ideas used in his persuasive letter to Mr Brodie. Well done, Kaedyn!</p>
<p><b>Sports Awards</b> Ayla - for being kind, considerate and having a go during Phys. Ed. Super, Ayla!</p>	<p><b>Sports Awards</b> Kaedyn - for being so helpful and thoughtful! Also for helping to set up and pack up equipment.</p>

## VALUES VAULT – Lexie

### SCHOOL VIRTUAL TOUR

<https://www.facebook.com/watch/?v=560547707944476>  
<https://www.tally-ps-3067.vic.edu.au/page/178/Enrolment>

# STUDENTS OF THE WEEK

## – Term 2 / Week 6

All students received a certificate and a free icy pole voucher.

<p><b>Foundation - Mrs H's Super Friends</b> <b>Eliza</b></p> 	<p>Eliza received this award for paying attention in class and always trying to do her best. Well done, Eliza!</p>
<p><b>Grade 1/2 – Miss P's Persistent Poppets</b> <b>Georgia</b></p> 	<p>Georgia is always a kind, caring and helpful student to everyone. She comes into the classroom every day with a positive attitude and tries her best with all learning tasks. Keep being an amazing human, Georgia!</p>
<p><b>Grade 3/4 - Miss R's Thriving 3/4s</b> <b>Braxton</b></p> 	<p>Braxton received this award for his eagerness to learn and his positive attitude towards his learning. Braxton always strives to do his best and looks for ways that he can extend and challenge himself. I love the way that Braxton contributes to our class discussions and shares his thoughts and ideas. Well done, Brax! Keep it up.</p>
<p><b>Grade 5/6 – Miss L's Lively Leopards</b> <b>Liam</b></p> 	<p>Liam received this award for settling back into our classroom routines after an extended absence. I have been very pleased with Liam's efforts. He has been quietly going about his learning tasks and working hard to remain focused. Well done, Liam!</p>

### VALUES VAULT – N/A



## TIME TO UPDATE!

Our school uses The Skool Loop App to communicate and send important information. Please check your app store to ensure your phone is running the latest version and receiving all school news.

The app undergoes regular maintenance and updates throughout the year. Check your app store to ensure your phone is running the latest version!







# Tallygaroopna Primary School

Thanks to the below businesses for sponsoring our school app:



**PEST CONTROL SHEPPARTON,  
MELBOURNE, REGIONAL VICTORIA &  
THE RIVERINA FOR OVER 20 YEARS**



**FLOORING < > TRA**  
Shepparton

If you would like to advertise on the Tallygaroopna Primary School Skool Loop App please email [Content@skoolloop.com](mailto:Content@skoolloop.com)



To download our app: In Google Play & App Store search 'Skool Loop' & choose Tallygaroopna Primary School once installed.

## Three Vs: Ventilation, Vaccination and Vital COVIDSafe Steps



\*Exemptions will only be for staff with a signed medical certificate

## Mobile Phone Policy Reminder

**There is a Late Arrivals/Early Departures book at the office, which needs to be signed for late arriving or early departing students. This needs to be signed by parents (or whoever is dropping off or picking up your child). There is also a Visitor's Book to be signed by all visitors to the school (this includes parents who stay for Parents' Club activities, etc). This will aid our emergency management of the school.**

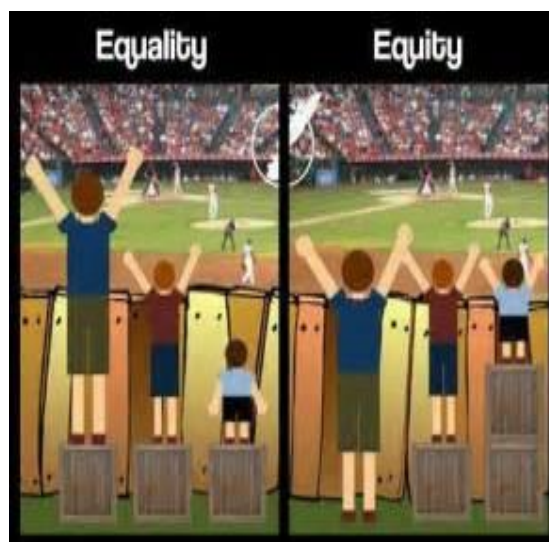

#### **Supervision – before and after school hours**

Parents are reminded that grounds supervision does not begin until 8.30am so please do not send students early to school for the sake of it or to play. This is documented in our staff supervision policy.

#### **Coronavirus (COVID-19) phone advice line**

For immediate questions and up to date guidance and advice, the Education Department has a dedicated coronavirus (COVID-19) phone advice line (9am-5pm Monday to Friday). The advice line is available for school leaders as well as all staff, and parents on 1800 338 663.

***STUDENTS ARE ABLE TO ACCESS SUNCREAM  
ON A REGULAR BASIS IF NEEDED.  
THIS SITS IN THE CUPBOARDS NEAR THE SINK IN THE PROJECT ROOM.***

***COLD WATER IS READILY AVAILABLE FOR EVERYONE AS WELL AT THE LARGE MIRROR  
IN THE PROJECT SPACE. ALL STUDENTS SHOULD HAVE A WATER BOTTLE TO UTILISE  
THROUGHOUT THE DAY.***

Our general school rule is to “consider the feelings of others at all times”.

School Website (COVID-19 / Remote Learning):  
<https://www.tally-ps-3067.vic.edu.au/page/238/COVID-19>

The Department's latest advice on coronavirus can be found at [www.education.vic.gov.au/coronavirus](http://www.education.vic.gov.au/coronavirus)

#### **Second-hand Uniforms**

If anyone has any uniforms that they no longer require could you please send them along to school.

## 1. Child Safe Standards

The Victorian Government has announced new [Child Safe Standards](#) to further strengthen child safety across organisations, including schools. The new standards recognise the critical importance of families and the broader school community in maintaining and promoting child safety and wellbeing. Tallygaroopna Primary School is currently reviewing and updating our child safety policies and procedures to ensure they meet the requirements of the new standards. These will be available via Skool Loop by hopefully Thursday 16<sup>th</sup> June.

We are committed to continuous improvement in our approach to child safety and wellbeing and welcome feedback from families and members of our school community on ways we can further strengthen our child safety policies, procedures and practices.

If you have any suggestions, comments or questions, please contact David Brodie (Principal) on 58298264.

## 2. School Reports

We will be aiming to distribute these in sealed envelopes on Monday 20th June. If parents would like some more feedback about individual student performance at school feel free to contact class teachers via Class Dojo. Teachers spend a lot of valuable time putting these together so please take the time to read them. Remember that these reports can be placed in the green report folders which some students at school may have. These can be purchased from the office for \$10.

The report cards have:

- \* a chart with an A-E rating (Well Above the Expected Standard – Well Below the Expected Standard), showing your child's current progress against the expected state-wide standard as well as the progress they have made since the previous year
- \* a chart showing your child's level of effort and class behaviour in a number of specific areas.
- \* details about attendance
- \* easy to understand comments from teachers outlining what your child knows and can do, any areas in which your child needs to be given further help or extended, and how this will be done.

### **What exactly do the A-E ratings mean?**

**A** indicates achievement that is **above the standard expected** for your child's year level at the time of reporting (12 months or more ahead of the standard expected at the time of reporting)

**B** indicates achievement that is **above the standard expected** for your child's year level at the time of reporting. It means that your child understands more complex ideas and has a broader range of skills than would normally be expected.

**C** indicates achievement that is **at the standard expected** for your child's year level at the time of reporting. It means that your child's learning is on track and that they understand and can apply the range of skills and knowledge expected for their year level at the time of reporting.

**D** indicates achievement that is **below the standard expected** for your child's year level at the time of reporting. It means that there are some skills and knowledge that your child has yet to acquire before they can be said to be achieving at the expected standard.

**E** indicates achievement that is **well below the standard expected** for your child's year level at the time of reporting. It means there are significant areas of knowledge and skills your child needs to acquire before they can be said to be achieving at the expected standard.

### **Isn't a 'C' a disappointing result?**

No it is not at all. It is important to remember that if your child receives a 'C' on the report card it indicates that their *learning is on track* and they are achieving the statewide standard that *is expected of them* at the time of reporting. In the past, a 'C' in some schools might have meant that the child was performing below the expected standard. This is no longer the case.

Updated goals and ILP's for some students (as per DET guidelines) will also go home in these envelopes. We anticipate that new goals for Semester 2 will go out to families early in Term 3.

## 3. Bus Driver – Temporary Replacement

Greg Frost will be going away for a few months and he will be replaced during this time by Craig Brauman. Craig will have his phone on silent obviously during all school bus trips but he can be contacted on 0419 775 868 if something is absolutely urgent. First port of call is to ring the Principal on 0411960164. Craig has made an attempt to meet some parents throughout this week at some drop offs and pickups - say g'day to him this week if possible to ensure a good working relationship for all.

#### **4. School Photos**

This day has been rescheduled to Tuesday 21<sup>st</sup> June – we hope that things may have settled down by then. As always, it is impossible to cater for everyone on the day but we hope that the most of our students and staff will be present on this day.

All current payments / photo envelopes will be held onto for this new date. Feel free to contact the school or photographers if any clarification is needed

#### **5. Kyabram Fauna Park**

We are planning a whole school excursion to the Kyabram Fauna Park on Thursday 16<sup>th</sup> June. This will involve a classroom session and a self-guided tour. We will be departing by bus at 9am and returning at 3pm. Permission forms are now due and the cost of the day is \$15 per student which includes bus travel and entry / program for the Kyabram Fauna Park. Approximately \$6 is being subsidised by the Parents' Club for each student which is greatly appreciated.

The venue requires a 1:10 adult to student supervisory ratio for our excursion to the Park. Staff attending will be: Mr Brodie, Mrs Haberfield, Miss Lothian, Miss Rosevear, Miss Puetz, Dee Palmer and Beck Wayman – if any parent helpers are needed further information will go out on Skool Loop soon.

#### **6. First Aid in Schools**

All students have an opportunity to participate in this program on Thursday 23<sup>rd</sup> June. There is no cost and no permission forms are necessary because this is an incursion held at school. The First Aid in Schools Program is a free program run by St. John Ambulance Australia providing basic first aid training to school students across all states and territories in Australia. The knowledge and skills gained in this program will develop First Aid awareness with our children and contribute towards building a more resilient community. The learning is age appropriate and integrates with the Victorian Essential Learning Standards (VELS) curriculum. Contact the school if you would prefer your child to not participate



#### **7. Bunnings BBQ**

Our school will be holding a fundraising BBQ at Bunnings on Sunday 12<sup>th</sup> June. All money raised on this day will go to the school for buildings and grounds. If any families are available to help on any of the times below could you leave names at the office please or respond via Skool Loop. It would be beneficial if we could have at least 2 to 3 families for each block. Children will not be able to use the BBQ facilities but they may assist with collecting money on the day. If any families can assist with eskies for this day it would be greatly appreciated.

Any donations of drinks, bread or sauce would be appreciated if you are unable to assist on the day. We need at least 2-3 families for each time slot to make this day run smoothly. Any support would be greatly appreciated.

8AM – 10AM	BRODIE, THOMAS
10AM – 12PM	KEMP, GRINTER
12PM – 2PM	RAYNER, BINION-HUTCHINSON, <b>Empty Spot</b>
2PM – 4PM	LITTLE – HARRIS, <b>Empty Spot</b>
4PM – 5PM	BRODIE, <b>Empty Spot</b>

**An updated roster will be put on Skool Loop, so that the necessary timeslots can be filled.**

**CURRICULUM DAY – FRIDAY 10<sup>TH</sup> JUNE / QUEENS BIRTHDAY – MONDAY 13<sup>TH</sup> JUNE**

## **8. Curriculum Days**

All schools are entitled to four Curriculum Days for the school year. The first was at the start of the year and two will focus on Report Writing. Specific dates are below.

Term 2: Friday 10<sup>th</sup> June (Curric Day 2)

Term 4: Monday 31<sup>st</sup> October (Curric Day 4)

Our 3<sup>rd</sup> Curriculum Day will be held in Term 3 on Monday 1<sup>st</sup> August with all staff attending Professional Learning with Andrew Fuller in Shepparton. Up to 200 local teachers will be in attendance on this day and a repeat session will also be held the following day. Andrew has recently been described as an "interesting mixture of Billy Connolly, Tim Winton and Frasier Crane" and as someone who "puts the heart back into psychology". As a clinical psychologist, Andrew Fuller works with many schools and communities in Australia and internationally, specialising in the wellbeing of young people and their families. He is a Fellow of the Department of Psychiatry and the Department of Learning and Educational Development at the University of Melbourne.



Again, there will be no school on this day and also no OSH Care so families will need to make alternative arrangements.

Andrew Fuller Website - <https://andrewfuller.com.au/about/>

## **9. Paws in Schools**

This began a few weeks ago and we look forward to giving other children in our school the opportunity to be involved in this program which focuses on supporting student wellbeing. In these sessions, facilitators will bring along specially trained therapy dogs to undertake wellbeing activities with each class. All students from F-6 will have the opportunity to take part. The next session will be held on Tuesday 14<sup>th</sup> June for Grade 1/2 students.

More info. about the PAWS in Schools program can be found here: <https://therapyanimals.org.au/paws-in-schools/>

## **10. RATS Available**

A reminder that RAT boxes continue to be available to be picked up at school – one per student and it would be appreciated if these are picked up by families ASAP. Ring the school on 5829 8264 if you are happy for your child to bring home a box please. As stated last week, there has been an extension with RATS for the remainder of Term 2.

## **11. Men's Shed Visits**

We are hoping to begin some Men's Shed visits again in Term 2. These will be held each fortnight on a Friday when time permits and will occur from 10am -11am. Specific information and consent forms have been sent home and children who return these will have the opportunity to spend a morning mixing with this community group.

## **12. Playgroup**

We will be looking into starting our Playgroup again soon probably on a Monday with Tim Ford – start date to be confirmed. This has been advertised on normal communication platforms. If you would like to attend, contact the school on 5829 8264, so that we can start planning for this to be implemented again. At present, we have received no interest.

## **13. Parents' Club Dates**

This week's Munch N Crunch is cancelled unfortunately because of the lack of helpers. The next Parents' Club Meeting will be held on Monday 25<sup>th</sup> July straight after school – all are welcome as always.

A number of dates have been set by the Parents' Club after the 1<sup>st</sup> meeting of the year. Dates remaining are summarised below and are subject to change depending on parent helpers:

4th August - Pie Munch n Crunch

26th August – Father's Day Activity

9th September - Hot Dog Munch n Crunch

14th October - Sausage Sizzle Munch n Crunch

2nd December - Wraps and Sushi Munch n Crunch

The Parents' Club are excited to bring activities to the students after a few quieter years due to COVID. Dates for 2022 have been locked in and support from families will be required for coordinating, volunteering time, shopping, cooking and more. If you can assist with any of these activities, please text Renee on 0407099050 or speak with Karen or David

#### **14. Daily Absences**

Can families submit any daily absences via Skool Loop on the day of absence please. Families can always submit multiple days on one message on Skool Loop as well. Mrs Armstrong will be texting families to follow up any daily absences and your assistance with this would be appreciated to allow for our formal processes to be improved.

**15. School Payments** - When making payment to the school bank account for multiple items, please make one direct deposit for the total amount with your family name listed and email the school a message detailing the breakdown of the payment.

#### **16. School Uniform - reminder**

A uniform dress code reinforces in students a pride in their own appearance, instils recognition of themselves as an integral part of the school community, and assists in developing pride in representing their school. A reminder to all families to reinforce this please. From May until the end of August, school beanies and scarves are permitted to be worn outside – beanies can be purchased from school in line with our uniform policy as well – we would appreciate green or red beanies and scarves only.

## **CAN APPROPRIATE UNIFORMS BE REINFORCED PLEASE – BLACK SHORTS OR PANTS.**

#### **17. School Council**

This will be held on Monday 20<sup>th</sup> June – Information will be distributed to School Councillors before the end of next week. As always, the Finance Committee will meet at 6pm followed by School Council at 6.45pm.

### **COVID -19 SCHOOL PROCESSES**

As of Thursday 19<sup>th</sup> May, we had 6 COVID-19 cases and there were 20 students absent on the one day - Thursday 19<sup>th</sup> May. As families would probably know there are again many cases in the Goulburn Valley Region and some schools have had to have cohorts of student return to Remote & Flexible learning. Therefore, all staff will be again asked to wear facemasks indoors and students from Grades 3-6 are encouraged to wear facemasks inside also. Any exceptions will still apply. Obviously, students in other grades (F-2) can wear facemasks if they wish.

I would like to reinforce that this is only encouraged not mandated. I have spoken to Steve Rogers (SEIL) about our current situation and he approves of facemasks being encouraged for staff and students in Grades 3-6 again for the time being.

Again, the health and safety of our whole school community is paramount and we are trying to avoid a further outbreak in our school community or potential closure. Thanks for your support in this matter - feel free to contact me if any clarification is needed.

David

#### **Communication Between Staff & Families – from Information Booklet**

Staff at Tallygaroopna Primary School value the relationship with families in our school community. Communication is vital and we ask that staff and family members strive to (where possible):

- Only contact each other between the hours of 8.00am – 5.00pm from Monday to Friday
- Only use the following platforms for communication between families and classroom teacher: Class Dojo or email
- Only use the following platforms for communication between families and the school: school phone, school email or Skool Loop.

In case of illness or injury of pupils, it is essential that we make contact with parents/guardians. Please ensure that the school has your **correct home** and **work phone numbers** and also the details of **another person** to contact who can act on your behalf if you are unavailable. The school office needs to be notified when there are any changes to this information.

# TALLY P.S. CALENDAR – TERM 2/3 2022 (ALL DATES TBC)

Mon	Tue	Wed	Thu	Fri
9 OSH Pet Program Open Day 2 Chaplain	10 OSH Tutoring Day 13  NAPLAN – Writ.	11 OSH Art / PE Pie Orders Due Chaplain	12 OSH  NAPLAN – Read	13 OSH Respectful Relat. Cross Country Div
16 OSH School Council 3 Chaplain  NAPLAN – Spel.	17 OSH Tutoring Day 14  NAPLAN - Maths	18 OSH Library / Music	19 OSH Rotation Day Munch N Crunch	20 OSH
23 OSH Chaplain	24 OSH Tutoring Day 15 Pies – Delivery Paws 2 (3/4)	25 OSH Art / PE Open Day 3 Chaplain	26 OSH	27 OSH Respectful Relat.
30 Prof. Practice Day – NO SCHOOL  PRINCIPAL CONFERENCE	31 OSH Tutoring Day 16 Chaplain	1 OSH Library / Music Open Day 4	2 OSH Rotation Day	3 OSH
6 OSH Chaplain	7 OSH Tutoring Day 17	8 OSH Art / PE Chaplain Respectful Relat.	9 OSH Open Day 5	10 Curriculum Day – Reports  NO SCHOOL Bunnings - 12th

Mon	Tue	Wed	Thu	Fri
13  QUEENS BDAY HOLIDAY	14 OSH Tutoring Day 18 Paws 3 (1/2)	15 OSH Library / Music	16 OSH Kyabram Fauna Park Excursion	17 OSH Region C. Country Open Day 6 Men's Shed
20 OSH Chaplain Reports Home School Council	21 OSH Tutoring Day 19 School Photo Day	22 OSH Art / PE Chaplain	23 OSH Open Day 7 First Aid in Schools	24 Respectful Relat. Last Day of T2 – Dismissal 2.25pm OSH – 5pm only
27	28	29	30	1
SCHOOL HOLIDAYS				
4	5	6	7	8
SCHOOL HOLIDAYS				
11 OSH Chaplain	12 OSH Tutoring Day 20	13 OSH Library / Music	14 OSH Rotation Day State C. Country	15 OSH

MAY / JUNE

JUNE / JULY