

# TALLYGAROPNA PRIMARY SCHOOL NO.3067

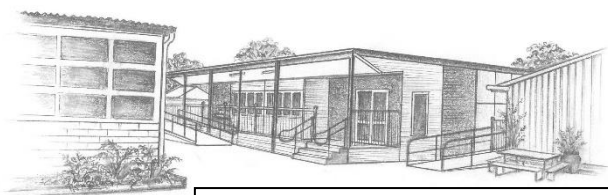

TERM 4 NO. 31 5<sup>th</sup> October 2020



Victoria Street, Tallygaropna

Phone 03 58298264

Fax 03 58298244

[tallygaropna.ps@education.vic.gov.au](mailto:tallygaropna.ps@education.vic.gov.au)

Website - <http://www.tally-ps-3067.vic.edu.au/>

Mobile 0411 960 164

Facebook Page - [Click here](#)

Small Schools Website - [Click here](#)

**SCHOOL VALUES - RESPECT, HONESTY & INCLUSION**

## News from the Principal's Desk

Dear parents, carers, students and staff

I would like to welcome everyone back to Tallygaropna PS for Term 4. It will be wonderful to see all of our students again and we hope that everyone had a restful term break. Unfortunately, there are still restrictions with adults coming into the school – please adhere to these and hopefully some may be lifted in the near future. Facemasks are paramount and we all need to continue to do our little bit during this difficult period. Some families were happy with the implementation of Remote Learning in Term 3, while others may have been disappointed. All I can tell you is that all staff worked extremely hard during this period and unfortunately, this situation was unprecedented and try as we did, it is always difficult to please everyone. Every family home was a different classroom and we tried to limit our expectations and pressures on our students, families and staff while following Department Guidelines. Please send me any feedback in regard to your experiences with Remote Learning using the schools email address above.

This is our 1<sup>st</sup> full edition of the newsletter for quite a while, so please read all items carefully and don't hesitate to contact me if any information needs to be clarified. Last night, we received the Operational Guidelines for Term 4 and we will update families of any changes ASAP. This may affect our Orientation Program for new Foundation students, which was planned to begin next week – stay tuned for more information before the end of the week.

We have advertised our OSH Care Coordinator position during the break and hope to announce a replacement for Toni Marie in the not too distant future. We are also currently working through school staffing arrangements for 2021 and hope to announce these at the beginning of November, as per normal. Keep safe everyone – I will no doubt see you all soon, even it is via Webex! Don't hesitate to contact me if any clarification is needed during this difficult time.

David Brodie  
(Principal)

**Can any Remote Learning work outstanding be handed back to the office ASAP please.**

A REMINDER TO FAMILIES THAT ASSEMBLY WILL BE HELD EACH FRIDAY AT 3PM VIA WEBEX (NUMBER – 576 739 057)  
LAST TERM, IT WAS WONDERFUL TO SEE SOME FAMILIES ATTEND ASSEMBLY AND WE HOPE THAT THIS CONTINUES INTO THE FUTURE. WE HOPE THAT OUR NORMAL ASSEMBLIES WILL OCCUR IN THE NOT TOO DISTANT FUTURE.

***A REMINDER TO ALL FAMILIES TO FREQUENTLY CHECK SKOOL LOOP BECAUSE MANY SPECIFIC EVENTS ARE PUT ON THIS RESOURCE INSTEAD OF THE NEWSLETTER. ALL FAMILIES WILL NEED TO JOIN NEW BOXES FOR 2020.***

***SCHOOL FEES ARE NOW DUE. COULD THESE BE PAID ASAP PLEASE.***

**Absence forms can be submitted on Skool Loop.**

***Please note the change of the school email address***

**OLD STUDENT TABLES WILL BE AVAILABLE FOR FAMILIES FOR A SIMPLE DONATION TO THE SCHOOL. THESE CAN BE COLLECTED BEGINNING ON FRIDAY 16<sup>TH</sup> OCTOBER.**

**MORE INFORMATION REGARDING THE ORIENTATION PROGRAM FOR NEW FOUNDATION STUDENTS WILL HOPEFULLY BE AVAILABLE BEFORE THE END OF THE WEEK.**

## DIRECT BANK DEPOSIT

Account Name:

Tallygaropna Primary School

BSB: 063—527

Account number: 0090 7788

**Please ensure you include family name and payment description as reference.**

Have you downloaded our School app yet?  
Never miss important school information again!



- ✓ Events
- ✓ Notices
- ✓ Instant school messages
- ✓ Absentee
- ✓ Newsletters
- ✓ Permission Slips



Available on the App Store  
Get it on Google play



**Simple free download:** In Google play & App Store search 'Skool Loop' & choose our school once installed.

### **COVID-19 Support Program**

The Education Department have some major priorities for students and staff for Term 4. Some of these are:

#### **Priority 1 – Wellbeing and Equity**

The wellbeing, and particularly the mental health, of every student and member of staff is the highest priority. This means encouraging and sustaining motivation for learning, re-engaging students and families where needed, and supporting the social and emotional learning of children and young people alongside curriculum-based learning.

This also means ensuring support for school staff, who have sustained their efforts through multiple transitions in modes of teaching and learning delivery.

#### **Priority 2 – Learning and Excellence**

Some students have been better able to progress in their learning in the remote and flexible learning environment, others have maintained their rate of progress, and some have, despite their best efforts and those of their families and teachers, not progressed in their learning. It will be important to meet all students at their point of need – both to support those who have not progressed in their learning to catch up and those who have progressed to continue to extend and stretch their learning. Literacy and numeracy across the curriculum remain a focus, with schools also adapting their teaching and learning program in Term 4 to be responsive to student needs.

As a result, our staff will be doing some 1 on 1 and small group instruction to support students in Term 4. To make this support program beneficial attendance at school is paramount – more information will be provided to families at the end of the week.

**STAY HOME STAY SAFE SAVE LIVES**

For all current restrictions visit [vic.gov.au/CORONAVIRUS](https://vic.gov.au/CORONAVIRUS)  
Authorised and published by the Victorian Government, 1 Treasury Place, Melbourne



# **BE YOU FACTSHEET**



## **Stress Management**

Stress is a normal reaction to life's changes and challenges. It can motivate us to get things done and to feel better about trying new things.

## **What causes stress?**

People experience stress for many reasons

One of the most common reasons is sudden or unexpected change, but even positive changes can be stressful. Expected changes – such as a child or young person starting at an early learning service or school, or changing between schools – can be also stressful.

Stress can be a response to a single event or might be prolonged, cumulative stress. Overwhelming stress impacts our physical and mental health, relationships, learning and development, and capacity to fulfil our roles (for example, parenting, working or studying).

Changes can happen in many aspects of a person's life at the same time, including shifts in their:

- physical environment (such as moving house or starting a new job)
- social environment (starting at a new school, feeling isolated after moving somewhere new, feeling they can't control or influence their environment)
- economic circumstances (such as an unexpected financial loss, large expense or job loss).

It's important to remember that stress is not anxiety – [an anxiety condition](#) is when someone:

- has anxious feelings which are consistently very intense
- have feelings that persist well after the stressful event has passed
- are so distressed that it interferes with their capacity to learn, socialise and do everyday things.

<https://beyou.edu.au/-/media/pdfs/fact-sheet-pdfs/stress-management.pdf>

<https://beyou.edu.au/fact-sheets/wellbeing>

## August OSH Care Newsletter 2020

Photos from our OSH service with the children having some delicious fairy bread, pancakes  
cupcakes & jellies for afternoon tea



Cool spies



Practicing to use the phone



Lego play

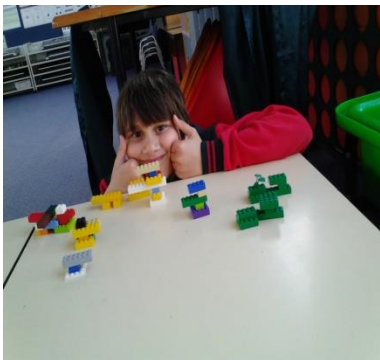

Scrabble game



Hangman time

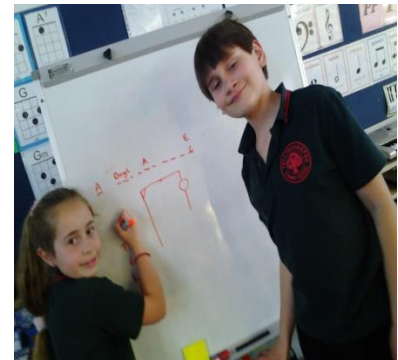



## September OSH Care Newsletter 2020

Photos from our OSH service with the children enjoying having some yummy honey joys, pancakes & apple muffins



Enjoying playing some tunes on the organ



Beating some tunes on the drum

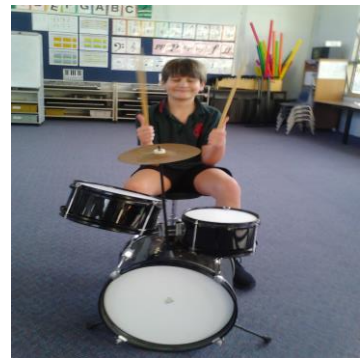

Playdough hotdog



Math time



Birthday toy

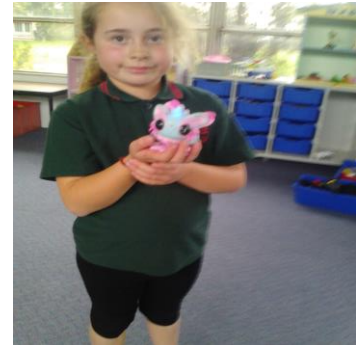

Slide time



Sandpit play





### **Coordinator - OSHC**

We are seeking a highly organized and dedicated individual to coordinate our OSHC (Outside School Hours Care) at Tallygaroopna PS commencing in 2021.

**Position:** Coordinator OSHC

**Hours:** Monday to Friday, 3pm-6pm  
(school terms only)

**Qualifications:** Diploma Children's Services or equivalent

Job description available upon request.

Contact David Brodie on 5829 8264

**Email applications to:**

[tallygaroopna.ps@education.vic.gov.au](mailto:tallygaroopna.ps@education.vic.gov.au)

**Applications close**

**Wednesday, November 11<sup>th</sup>, 2020.**

***Music Lessons – 2020 (we hope to begin these again on Monday 12<sup>th</sup> October – families will be contacted this week).***

*Cliff Doornkamp is offering individual guitar and keyboard lessons to be held on a Monday morning. Each lesson runs for 20 minutes and will cost \$20. Interested families should contact Cliff on 0474 769 963 for more information.*



## REMOTE LEARNING PHOTOS

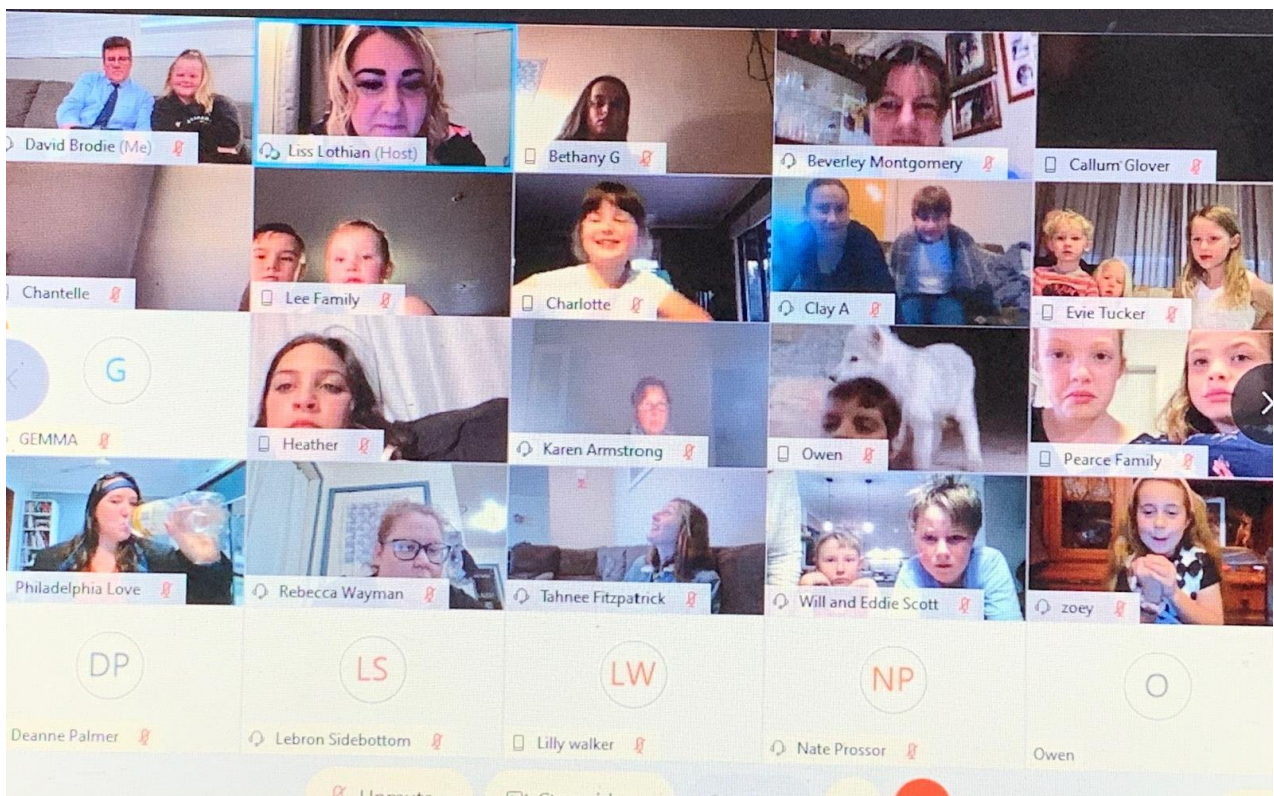
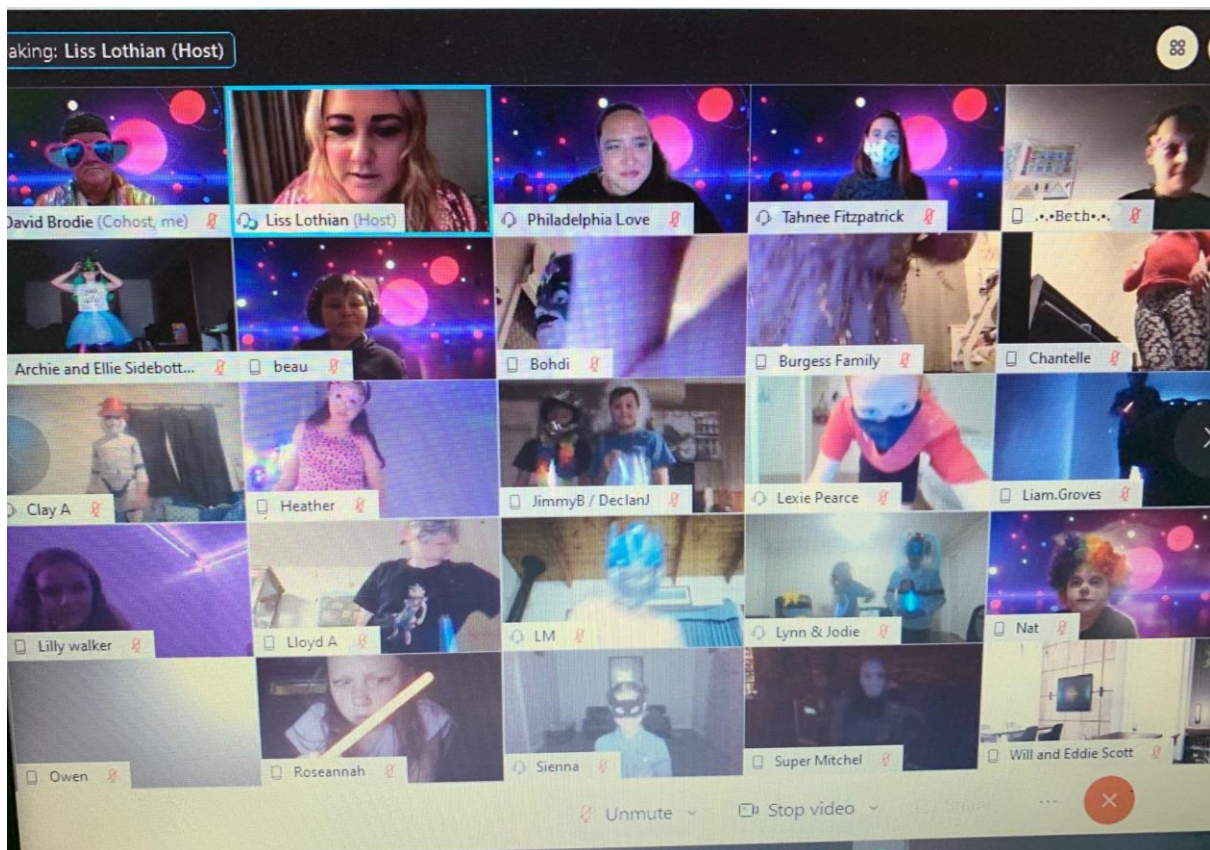



## REMOTE LEARNING PHOTOS

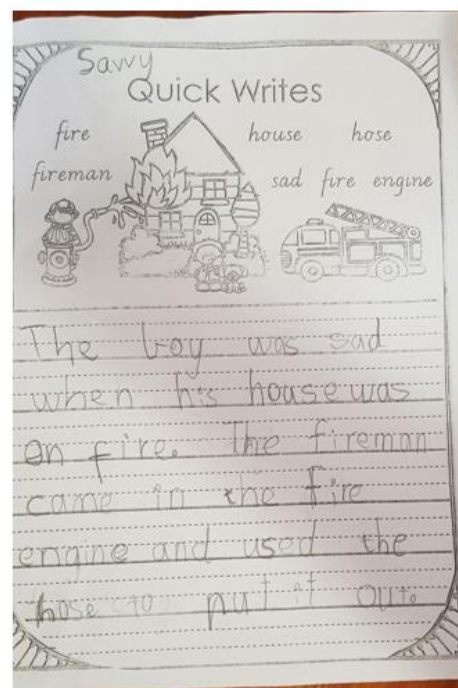
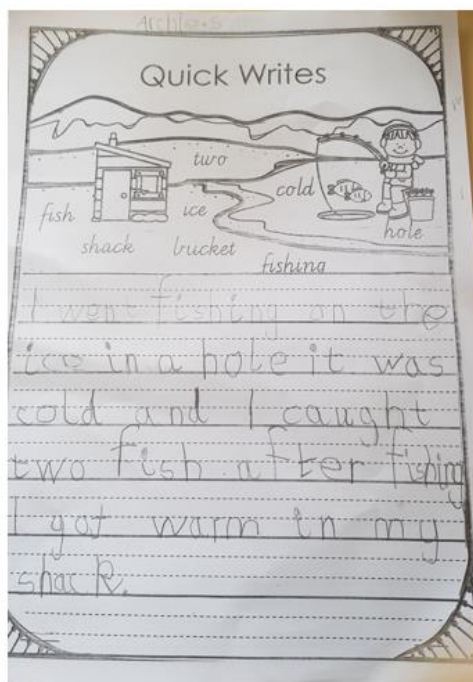



# **ALL PRIMARY SCHOOL STUDENTS DO NOT NEED TO HAVE A FACE COVERING AT SCHOOL.**

**Everyone 12 years and over entering school grounds must wear a face covering**



For detailed information visit:  
<https://www.dhhs.vic.gov.au/coronavirus>



## **FACE MASKS AND COVERINGS**

Normal COVID-19 processes will continue at school for the time being. These include:

- \* Families are not to enter the school grounds at any time – utilise the front and back of the school for pick ups and drop offs and social distance please.
- \* 8.45am arrivals to continue at this point - this assists with extensive morning cleaning.
- \* Family Drop Off arrangements to continue at this point. Collection points are: A-L: front car park, M-Z: back of the school gate.
- \* No sharing of food between students and staff – no birthday treats, pie warmers or icy poles.

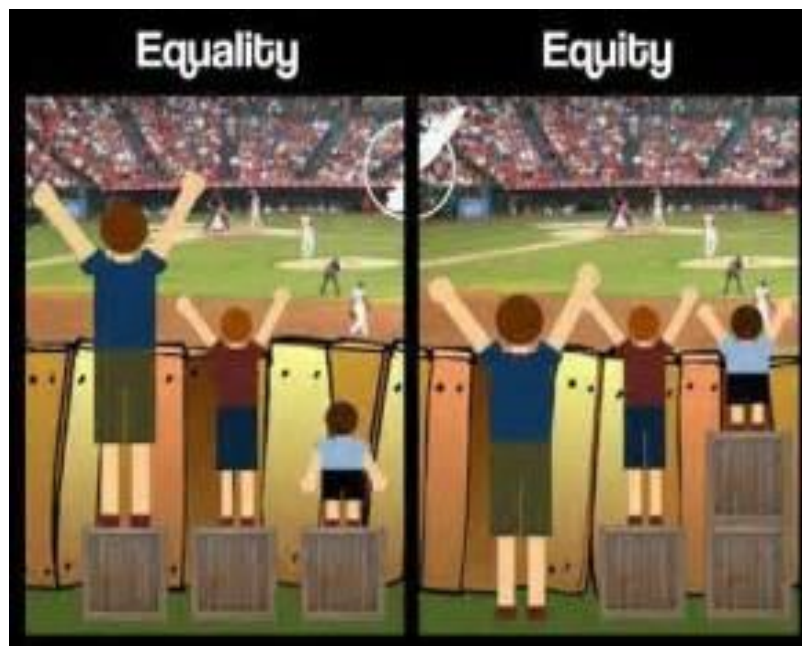

The Child Safe Standards are compulsory minimum standards for all Victorian early childhood services and schools, to ensure they are well prepared to protect children from abuse and neglect. The standards provide a framework for schools to review existing policies and practices and all other aspects of child safety, to ensure a 'zero tolerance' approach to any form of child abuse. You can access our policy on the school's website.

### Fairleys Supa IGA Community Rewards Program

Our school is registered for the Fairleys Supa IGA Community Rewards program. Families can register in-store.

Funds generated by customer point donations are converted to cash and handed over at the end of the financial year.

*Introducing*

**FAIRLEYS**

**SUPA IGA**

*Community*

**REWARDS**

FUNDRAISING PROGRAM

**Please Help Financially Support  
Your School... Join Today!**



[fairleysiga.com.au](http://fairleysiga.com.au)

We are

**eSmart®**

The Alannah  
and Madeline  
Foundation  
Keeping children safe from violence





## **2021 Enrolments**

- **Planning has commenced for 2021 class structures. We hope to announce this early in November as it has been in past years.**
- **Have you notified the school about your child starting Foundation?**
- **Have you notified the school if your child won't be here in 2021?**
- **To assist us with our planning, please remind other school families to enrol their child**

**If you have a query, contact David or Karen  
on 03 58 298264**



# Orientation Program for 2020

Tallygaroopna PS



## Foundation Transition Program

The following days have been scheduled for new Foundation students for 2021. This Orientation Program is essential to starting school. Confirmed dates are below.

Day 1 – Tuesday 13th October (9am – 11am) Kinder Day – walk kids back at 11am

Day 2 – Tuesday 27th October (9am – 11.40am) Kinder Day – walk kids back at 11.30am

Day 3 – Wednesday 11th November (9am – 1.55pm) Kinder Day – pick up from school at 2pm

Day 4 – Wednesday 25th November (9am – 1.55pm) Kinder Day – pick up from school at 2pm

Day 5 (Statewide) – Tuesday 8th December (all day)

**ALL DATES ARE SUBJECT TO COVID-19 RESTRICTIONS**  
**AND NEED TO BE CONFIRMED STILL. APOLOGIES FOR ANY**  
**INCONVENIENCE**





## Reduce your risk of coronavirus

- ✎ **WASH** your hands often with soap and running water, for at least 20 seconds. Dry with paper towel or hand dryer.
- ✎ **TRY** not to touch your eyes, nose or mouth.
- ✎ **COVER** your nose and mouth with a tissue when you cough or sneeze. If you don't have a tissue cough or sneeze into your upper sleeve or elbow.
- ✎ **STAY** at home if you feel sick. If you take medication make sure you have enough.
- ✎ **PHONE** your doctor or the hotline – **1800 675 398** – if you need medical attention. They will tell you what to do.
- ✎ **CONTINUE** healthy habits: exercise, drink water, get plenty of sleep.
- ✎ **WEARING** a face mask is not necessary if you are well.
- ✎ **BUY** an alcohol-based hand sanitiser with over 60% alcohol.



Find out more  
[www.dhhs.vic.gov.au/coronavirus](http://www.dhhs.vic.gov.au/coronavirus)

If you are concerned, call the  
**Coronavirus hotline 1800 675 398 (24 hours)**  
Please keep Triple Zero (000) for emergencies only

To receive this publication in an accessible format email [COVID-19@dhhs.vic.gov.au](mailto:COVID-19@dhhs.vic.gov.au)  
Authorised and published by the Victorian Government, 1 Treasury Place, Melbourne.  
© State of Victoria, March 2020. (20 01628\_v1)



## Coronavirus (COVID-19) phone advice line

For immediate questions and up to date guidance and advice, the Education Department also has a dedicated coronavirus (COVID-19) phone advice line (9am-5pm Monday to Friday). The advice line is available for school leaders as well as all staff, and parents on 1800 338 663.

## SCHOOL VIRTUAL TOUR

<https://www.facebook.com/watch/?v=560547707944476>  
<https://www.tally-ps-3067.vic.edu.au/page/178/Enrolment>

## **Photos of the Week – New Foundation Students for 2021**

We welcome Georgia, Amelia and Lachie to our school community. We are anticipating 9 new Foundation students for 2021 who will begin their journey into primary school over the coming weeks.





**1. Welcome** – Welcome to Nathaniel (Grade 5), Paige (Grade 5), Bailey (Grade 6), Seth (Foundation) and Skylah (Grade 2) to our school community. We also welcome their families as they join our school during these extraordinary times during COVID-19. I am sure we will welcome all students to our school with open arms - our current enrolment at Tallygaroopna Primary School is 86 students.

**2. Building Works** – Upgrade works on our portable has been approved. It is planned for works to commence on Friday 16<sup>th</sup> October and be completed by Wednesday 21<sup>st</sup> October. A scope of works has been approved by the VSBA for our portable and we hope there will be limited disruptions during this time. The building works will address the following:

- Roof
- Structural / Sub-floor
- Internal Wall Linings
- Floor Coverings
- Flooring Soundness

We have a number of new shelves to assemble for this portable. If you can assist with this please contact the school.



**3. OSH Care Position** – As stated previously, unfortunately Toni Marie will be leaving our OSH Care service at the end of the year. As a result, we have recently advertised to fill this position and if any members of the school community know of anyone who may be interested please ask them to contact the school ASAP.

We will continue to discuss OSH Care and how financially viable this is for the school going forward at School Council. Please support this service if you can so that we can maintain it for the future for our school community. An expression of interest form will be sent home soon seeking permanent or casual places for 2021. Please return this ASAP.

**4. Parent Opinion Survey** – This survey seeks parents' and carers' opinions on school climate, student engagement, and effective teaching practice known to influence student outcomes, as well as their experiences of remote and flexible learning. We anticipate that this survey will be offered to parents and carers to complete online from Monday 12 October to Friday 13 November – stay tuned for more information.

The survey can be administered remotely by schools distributing survey links and instructions to parents and carers through their school management system, school bulletin or newsletter. ORIMA Research will provide schools with draft newsletter text and communications support.

**5. School Council** – The next meeting is scheduled for Tuesday 20<sup>th</sup> of October. At this stage, this meeting will still be held via Webex with Finance beginning at 6pm and School Council beginning at 6.45pm. Information regarding this meeting will be sent to School Councillors next week.

**6. End of Year Excursion** – We have made a temporary booking for Funfields at Whittlesea for our end of year excursion. This is for Friday 11<sup>th</sup> December - reservations will remain tentative until a Booking Form is sent, completed and returned to Funfields. Costs will be confirmed at a later date - hopefully we have some clear answers about these uncertain situations in the coming weeks.

**7. Orientation Program (new Foundation students)** – Our Orientation Program for new Foundation students was scheduled to begin in Week 2 next term. We await advice from the Education Department in regard to whether this program can be implemented in line with COVID-19.

**8. School Photos** – This has now been rescheduled to be held on Thursday 15th October – more details will go out on Skool Loop this week, but we anticipate that the photos will begin between midday and 1pm.

**9. Hats** – In line with our Sun Smart program, hats are now mandated although we will have a grace period for Monday and Tuesday. All students and staff will now need their school hat and children without a hat will need to be in the undercover area or in the Multipurpose Room during recess.

**10. Remote Learning Legends** – Congratulations to Olie, Harry, Ellie and Bethany on receiving the last Remote Learning Legends awards. It was fantastic to see the effort our students were putting into their learning – well done everyone. These awards focused on positivity with Remote Learning.

**11. Outdoor Learning Space** – If anyone has any large logs or boulders that they could transport and donate to this project it would be greatly appreciated. Feel free to contact the school if you have any ideas or if you can support this project in anyway. We will be aiming to lay some compressed rock at the front of this area soon.

**A BIG THANK YOU TO STACEY TOWERS AND MARK LEE FOR THE KIND DONATION OF SOME WOOD FOR OUR OUTDOOR LEARNING SPACE. THE MEN'S SHED HAVE ALSO KINDLY OFFERED TO HELP WITH SOME SEATING FOR THIS AREA – STAY TUNED FOR MORE DETAILS.**

**12. Facemasks** – A reminder to everyone in the school community to wear face masks (not students). No families are to come into the school grounds for the foreseeable future - contact the school on 58298264 and wait in the school car park for specific instructions in regard to pick up...etc. This is for our OSH Care service as well.

A summary of information regarding the wearing of face coverings for staff is included below.

| Do's   | Optional  |
|--|---|
| <ol style="list-style-type: none"><li>1. in the staff room</li><li>2. on yard duty</li><li>3. on your way to and from school</li><li>4. temperature checking</li><li>5. administering first aid</li><li>6. remember to still follow physical distancing and hand hygiene</li></ol> | <ol style="list-style-type: none"><li>1. when teaching</li><li>2. when on video meetings with students</li></ol> <p><u>See signage around the school!</u></p> |

Information for families:

- In accordance with requirements from the Victorian Government, primary school students are not required to wear a face covering irrespective of the student's age.
- Parents, guardians and carers are encouraged to inform their child/ren that school staff will be using face coverings and reinforce with their child/ren the need to keep 1.5 metres apart from other people, to wash and dry hands thoroughly and regularly, and cough and sneeze into a tissue or their elbow.
- Parents and carers will be required to wear face coverings whenever they leave the house, including for school drop off and pick up. If they are travelling in a car alone, or only with members of their household, they do not need to wear a mask. Parents and carers are required to wear a mask if they are required to collect an unwell child/ren from the school. If you require clarification in relation to the use of face coverings please contact me.

**13. OSH Care** – Could families planning to use the OSH service please let us know as soon as possible so that we can book in Toni-Marie.

**14. Student of the Week** – This will resume this week and will be announced over the PA each Thursday as per normal. Families will be notified and encouraged to attend assembly which will still be held over Webex at 3pm each Friday.

**15. New Enrolments (2021)** – Information has been sent to the Kinder in regard to future enrolments for 2021 and was also posted on Facebook. Planning for the new year begins early. Some restrictions are in place with what we can and can't do at the moment in regard to tours during school hours. We hope normal school tours during school hours will be available at some stage. Enrolment forms and information can be collected at the office - it would be great if these are returned now to assist with planning for 2021. If any families plan on leaving Tallygaroopna PS can you also let us know to assist with planning.



## **16. School Fees**

School fees for 2020 are now due. These were itemised in the letter sent home at the start of the year.

They are as follows:

**Foundation - \$217**

**Grade 1/2 - \$170**

**Grade 3/4 - \$150,**

**Grade 5/6 - \$155**

These fees do not include excursions, swimming, camps or bus fees (for applicable families).

Our general school rule is to “consider the feelings of others at all times”.

School Website (COVID-19 / Remote Learning):

<https://www.tally-ps-3067.vic.edu.au/page/238/COVID-19>

The Department’s latest advice on coronavirus can be found

at [www.education.vic.gov.au/coronavirus](http://www.education.vic.gov.au/coronavirus)

Principal Webex Meeting ID - 576 739 057 (Assembly each Friday at 3pm)

## **Second-hand Uniforms**

If anyone has any uniforms that they no longer require  
could you please send them along to school.

Student accident insurance, ambulance cover  
arrangements and private property brought  
to school.

A reminder that Schools do not provide personal  
accident insurance or ambulance cover for students.  
Parents and guardians of students, who do not have  
student accident insurance/ambulance cover, are  
responsible for paying the cost of medical treatment for  
injured students, including the cost of ambulance  
attendance or transport as well as any other transport  
costs.

Private property brought to school by students or visitors  
is not insured and the Department does not accept any  
responsibility for loss or damage.

## NORTHERNERS CRICKET CLUB

Attention Juniors 🏏🏏

While we are working really hard to get training dates set and the kids back on the track... here is what we know:

We will be fielding the following teams:

U16s - Coach Matt Hall (Saturday morning games)

U14s - Coaches Shane & Glen Davidson (Saturday morning games)

U12s - Coach required (Friday evening games)

U10s - Coach required (Wednesday evening games)

Each team will also require a Covid safe officer - anyone willing to do this, please let me know and I will get in touch with details.

We are not able to field a team without a coach and covid officer.

Unfortunately, there will be no club kits, each child will require their own gear (thanks Covid). If you need help with this, please ask around as there may be older kids willing to donate or sell preloved gear.

16s and 14s first game will be 20/20 grading match on 17/10. Season will then start on 7/11.

12s first game will be grading match on 16/10 and then season start on 6/11.

10s will start 11/11

An email invite to register will be sent soon, together with an email reminder of your child's player ID number for registration. We will also post this registration link on this page in coming days for those registering for the first time.

Thanks so much for your patience 😊

Please contact Lori Hall on 0408 145 577 or [milihall@bigpond.net.au](mailto:milihall@bigpond.net.au) for further information

## **Family Care (Online workshops) - registrations now open**

Tuning in to Kids – 6 sessions commencing 6 October – register [here](#)

Emotion Coaching – 15 October – register [here](#)

Connections – 8 sessions commencing 21 October – [call Child FIRST to register 1300 854 944](#)

Real Men Make Great Dads – 8 sessions commencing 22 October – [call Child FIRST to register 1300 854 944](#)

Emotion Coaching – 4 November – register [here](#)

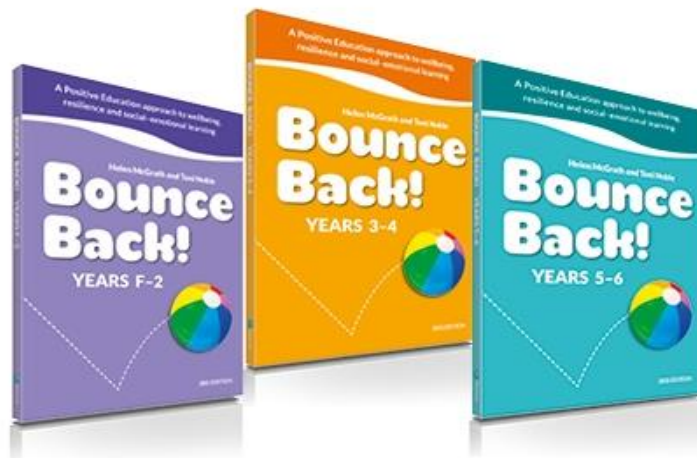

### Facebook a Reminder

Just a friendly reminder not to post photos of students that you have taken at school events on your own Facebook page, without notifying the child's parent first. Thank you for your ongoing support with this.

**facebook**  
REMINDER



# **TALLY P.S. CALENDAR – TERM 4 2020 (ALL DATES TBC)**

| Mon                       | Tue  | Wed                                   | Thu                         | Fri                                       |
|---------------------------|--|---------------------------------------|-----------------------------|---|
| 6                         | 7  | 8                                     | 9                           | 10  |
| <b>SCHOOL HOLIDAYS</b>    |  |                                       |                             |   |
| 5<br>Term 4 Starts<br>OSH | 6<br>Chaplain<br>OSH                       | 7<br>Chaplain<br>OSH<br>Library / PE  | 8<br>OSH                    | 9<br>OSH<br>Music<br>Assembly – 3pm       |
| 12<br>OSH                 | 13<br>Chaplain<br>OSH<br>Orientation Day 1 | 14<br>OSH<br>Art / Science            | 15<br>OSH<br>School Photos  | 16<br>OSH<br>Italian<br>Assembly – 3pm    |
| 19<br>OSH                 | 20<br>Chaplain<br>OSH<br>School Council    | 21<br>Chaplain<br>OSH<br>Library / PE | 22<br>OSH<br>Assembly – 3pm | 23<br>Public Holiday –<br>AFL Grand Final |
| 26<br>OSH                 | 27<br>Chaplain<br>OSH<br>Orientation Day 2 | 28<br>OSH<br>Art / Science            | 29<br>OSH                   | 30<br>OSH<br>Italian<br>Assembly – 3pm    |

**OCTOBER**

| Mon                                      | Tue  | Wed   | Thu       | Fri                                    |
|--|--|---|-----------|--|
| 2<br>OSH                                 | 3<br>Melbourne Cup                                       | 4<br>Chaplain<br>OSH<br>Library / PE          | 5<br>OSH  | 6<br>OSH<br>Music<br>Assembly – 3pm    |
| 9<br>OSH                                 | 10<br>Chaplain<br>OSH<br>Bravehearts<br>Yachting Program | 11<br>OSH<br>Art / Science<br>Orientat. Day 3 | 12<br>OSH | 13<br>OSH<br>Italian<br>Assembly – 3pm |
| 16<br>OSH                                | 17<br>Chaplain<br>OSH                                    | 18<br>Chaplain<br>OSH<br>Library / PE         | 19<br>OSH | 20<br>OSH<br>Music<br>Assembly – 3pm   |
| 23<br>Curriculum Day –<br>Report Writing | 24<br>Chaplain<br>OSH                                    | 25<br>OSH<br>Art / Science<br>Orientat. Day 4 | 26<br>OSH | 27<br>OSH<br>Italian<br>Assembly – 3pm |
| 30<br>OSH                                | 1<br>Chaplain<br>OSH                                     | 2<br>Chaplain<br>OSH<br>Library / PE          | 3<br>OSH  | 4<br>OSH<br>Music<br>Assembly – 3pm    |

**NOVEMBER / DECEMBER**